

ACTION

DIAL

SLG

TRANS

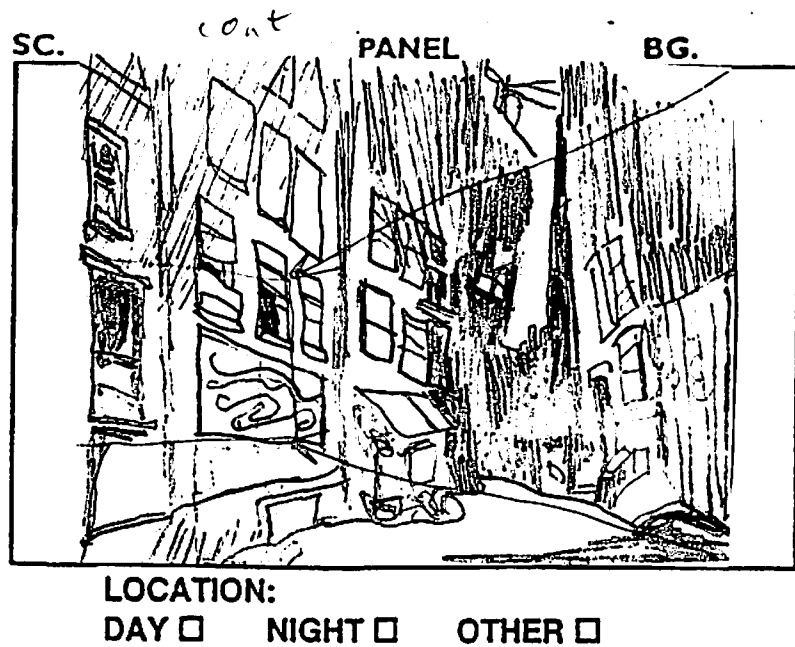

ACTION

EXT. NICE NEIGHBORHOOD - NIGHT.

DIAL

SLG

TRANS

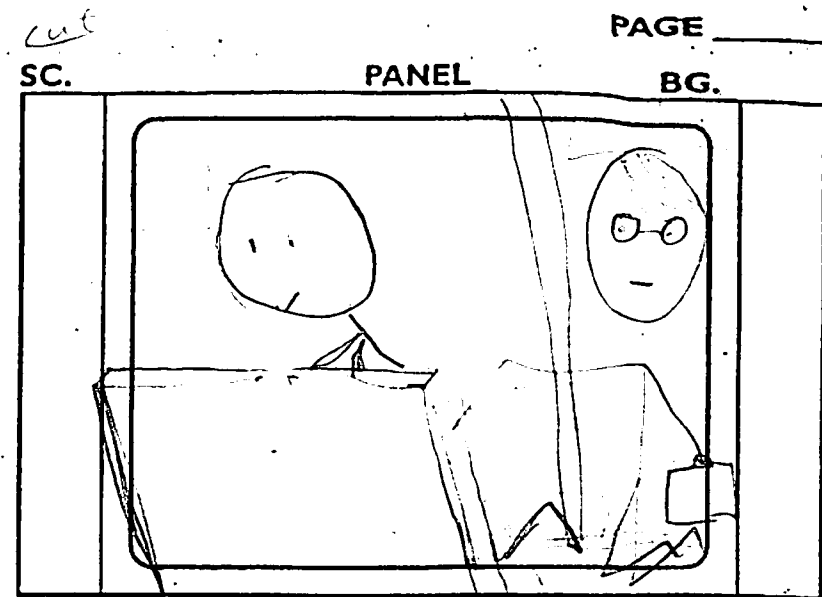

ACTION

Ellen taps on Milt's shoulder.
Milt is messing around

INT. NICE NEIGHBORHOOD APT.

DIAL

SLG being director

TRANS lation

Luv, written and drawn by Anne Toole

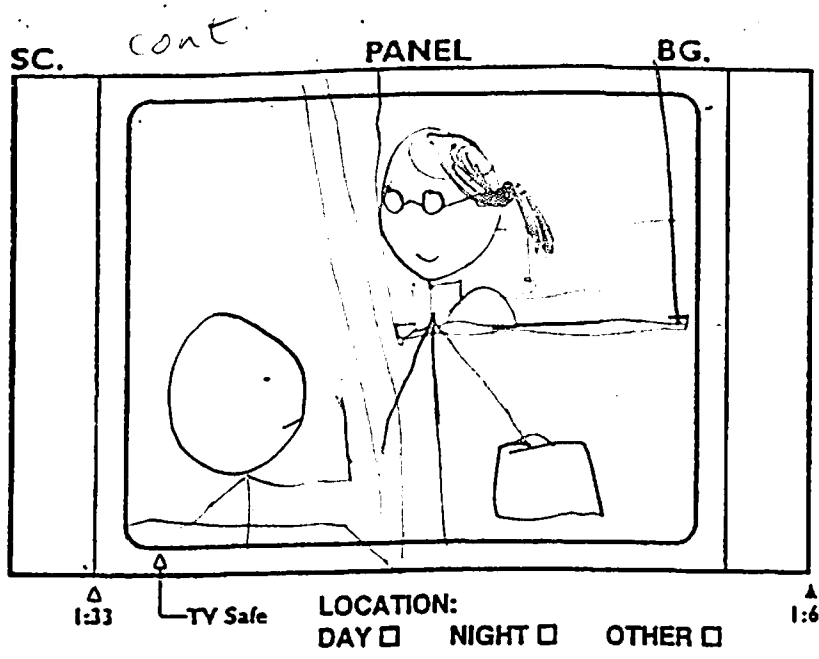

1:33 TV Safe LOCATION: DAY NIGHT OTHER 1:66

ACTION
Milt waves Ellen away, then she says:

DIAL
E: What I have to say will only take a few minutes.

SLG

TRANS

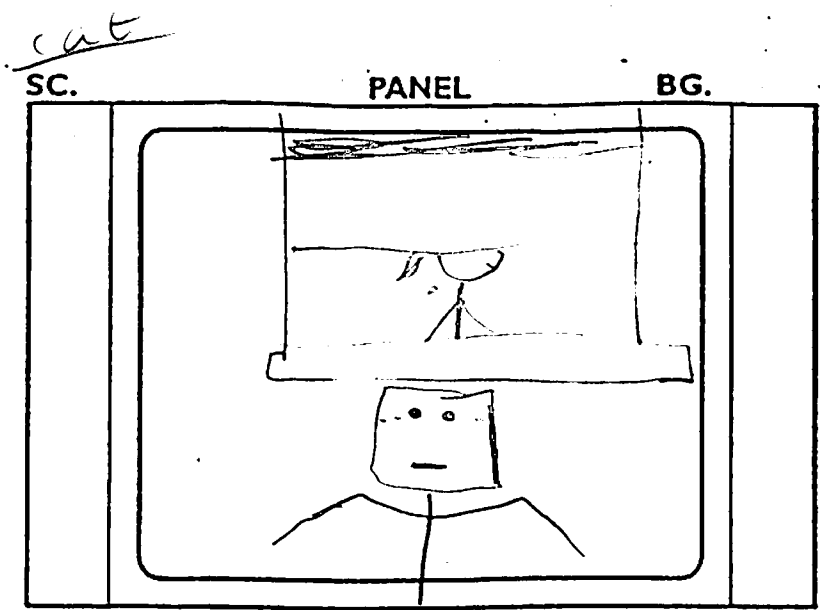

LOCATION: DAY NIGHT OTHER

ACTION
Man lurks outside window.

DIAL
E (O.S.): There may not be many more of them.

SLG

TRANS

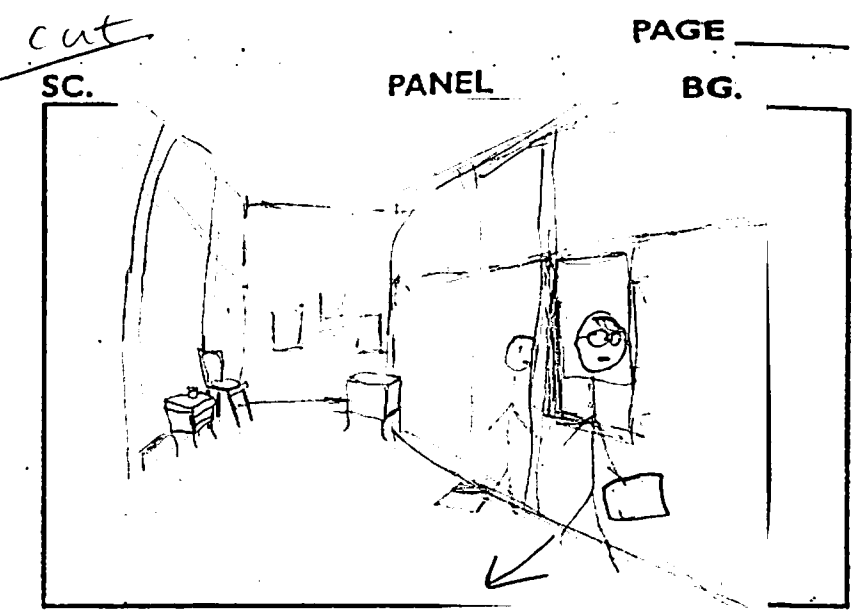

LOCATION: DAY NIGHT OTHER

ACTION
Ellen moves forward and out of frame as Milt leans against the wall and looks after her.

DIAL
E: You didn't rape her until

SLG *ing director*

TRANS *ation*

cut

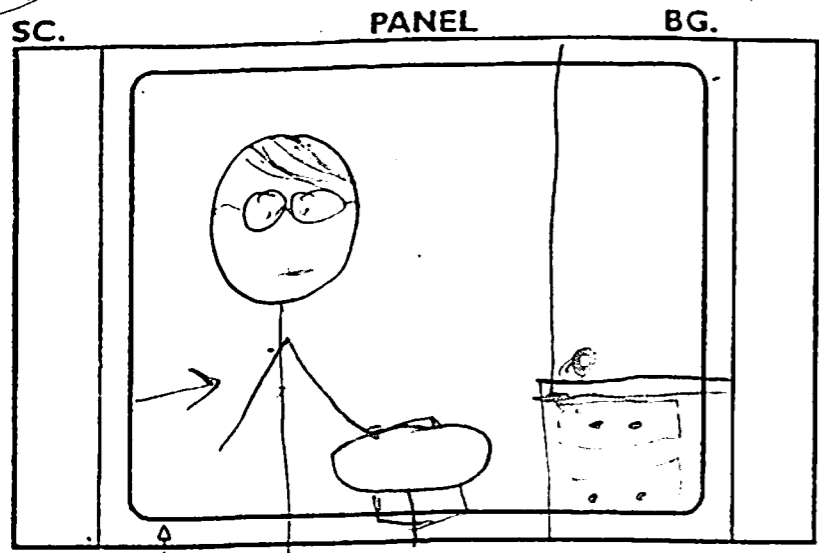

SC. PANEL BG.
 Δ 1:33 TV Safe LOCATION: DAY NIGHT OTHER Δ 1:66

ACTION
 Ellen moves to a chair.
 A door behind her is blocked by a dresser.

DIAL
 El: after one last night.

SLG

TRANS

cut

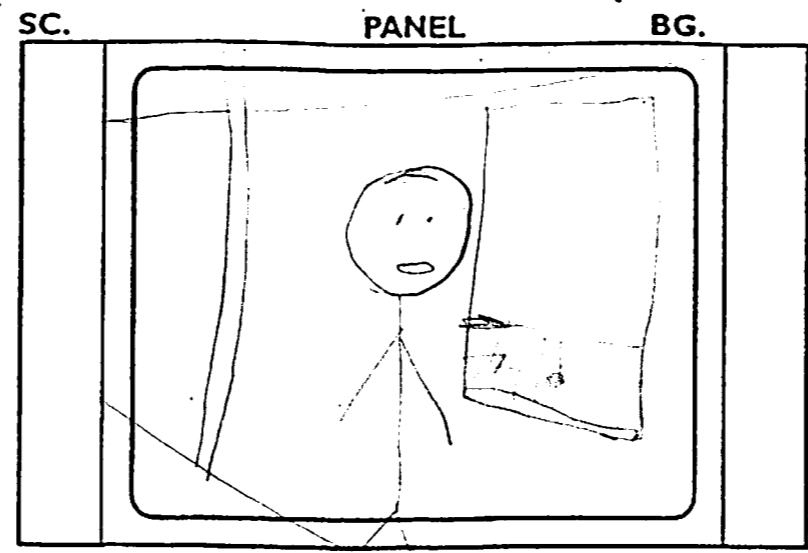

SC. PANEL BG.
 LOCATION: DAY NIGHT OTHER

ACTION

DIAL
 Milt: I told you what happened here.

SLG

TRANS

cut

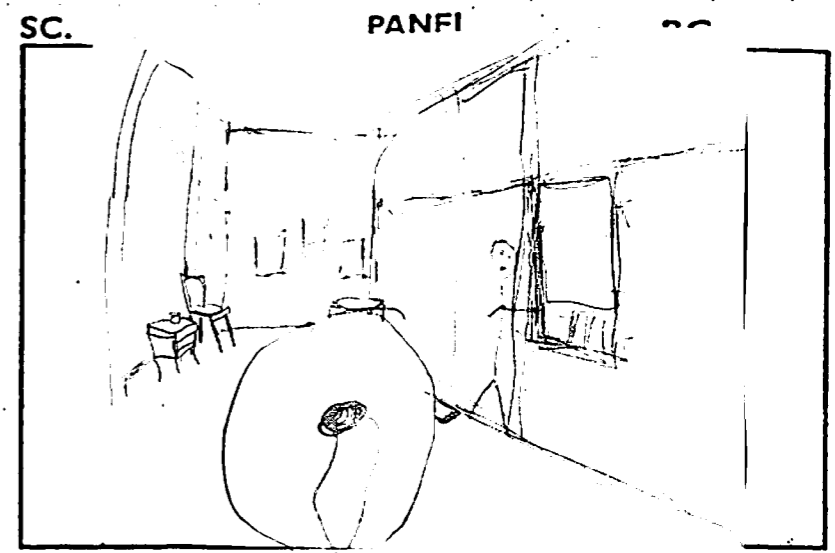

SC. PANFI
 LOCATION: DAY NIGHT OTHER

ACTION

DIAL
 Milt: I was stuck in the office.

SLG *ing director*

TRANS *ation*

SC. PANEL BG.

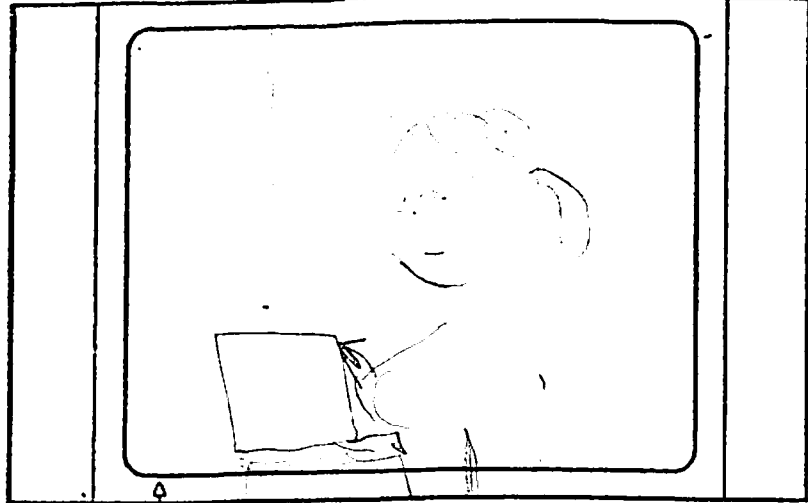

1:33 TV Safe LOCATION: DAY NIGHT OTHER 1:66

ACTION

Ellen opens her laptop,
half listening.

DIAL

Milt (O.S.): These clients come
and the boss was here

SLG

TRANS

cut
SC. PANEL BG.

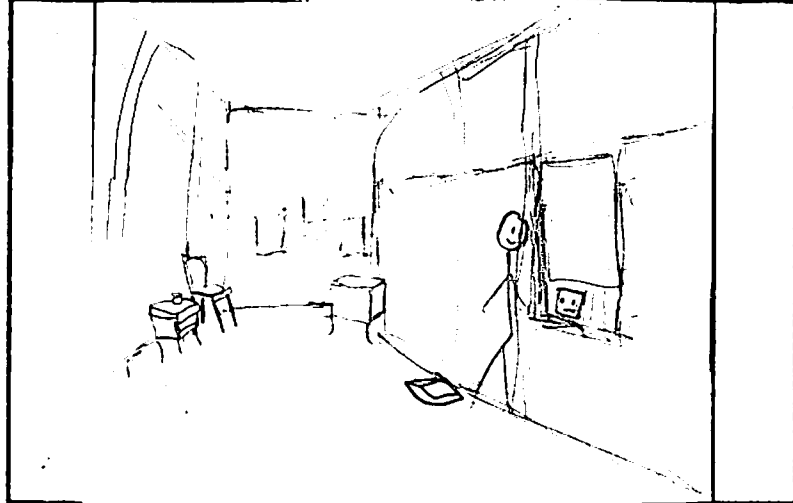

LOCATION: DAY NIGHT OTHER

ACTION

Milt is talking as a face
appears in the window

DIAL

and I couldn't.
Ellen (O.S.): Milt.

SLG

TRANS

cut
SC. PANEL BG. PAGE _____

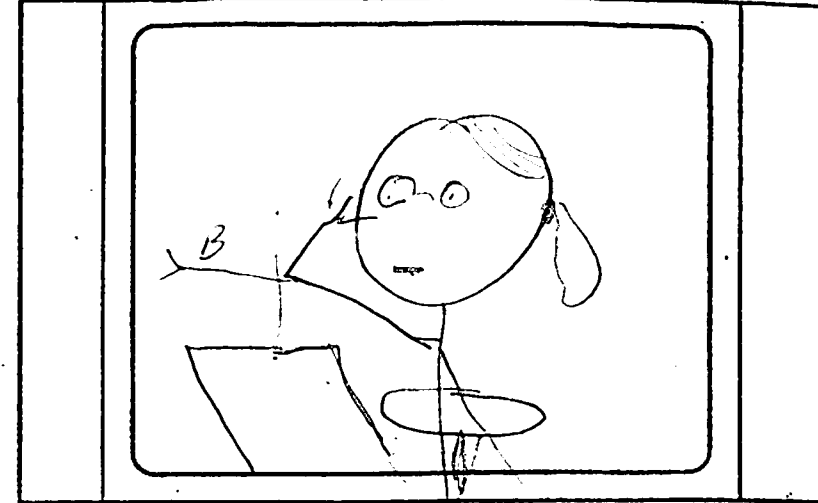

LOCATION: DAY NIGHT OTHER

ACTION

Ellen ^A points at her eyes
then ^B points O.S.

DIAL

SLG ...ing director

TRANS action

cut

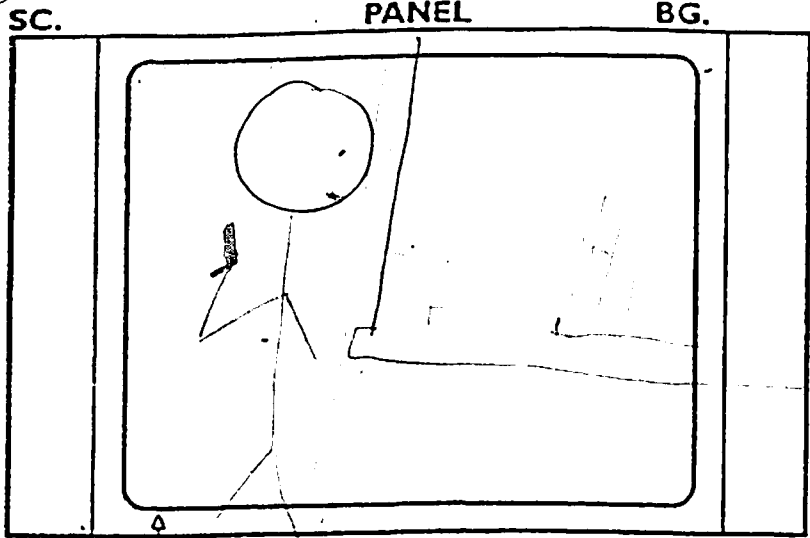

1:33 TV Safe 1:66
 LOCATION: DAY NIGHT OTHER

ACTION
 Mitt pulls a gun & looks out the window. The face has disappeared.

DIAL

SLG

TRANS

cut

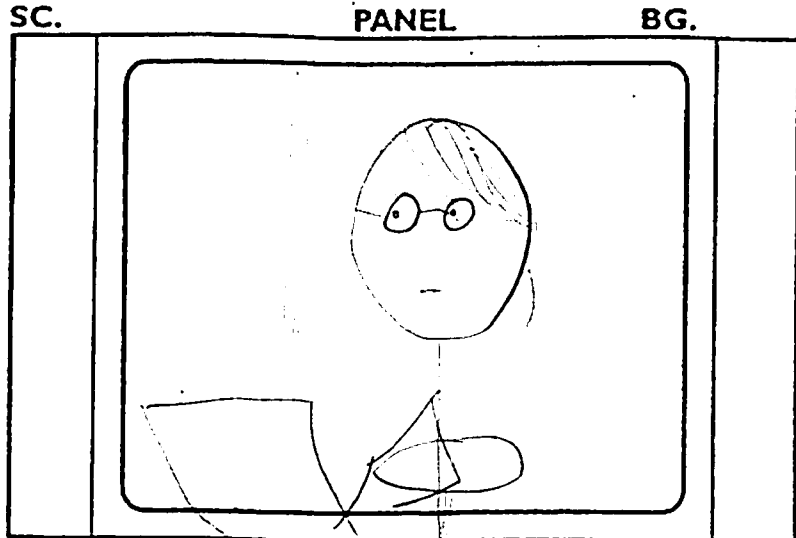

LOCATION: DAY NIGHT OTHER

ACTION
 Ellen looks at O.S. Mitt disbelievingly.

DIAL

Mitt (O.S.): It's the truth, & I!

SLG

TRANS

cut

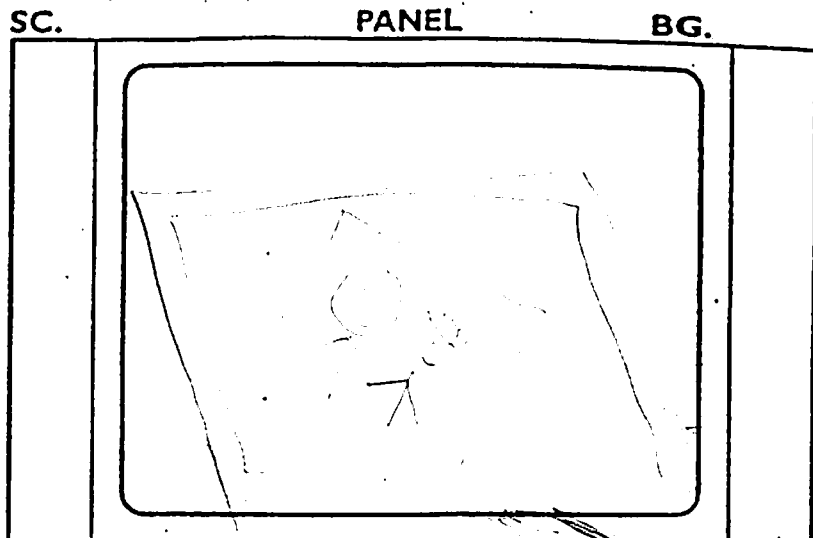

LOCATION: DAY NIGHT OTHER

ACTION
 Ellen's Computer screen shows a picture of Mitt & Ellen smiling.

DIAL

SLG ...ing director

TRANS lation

SC. *cont* PANEL BG.

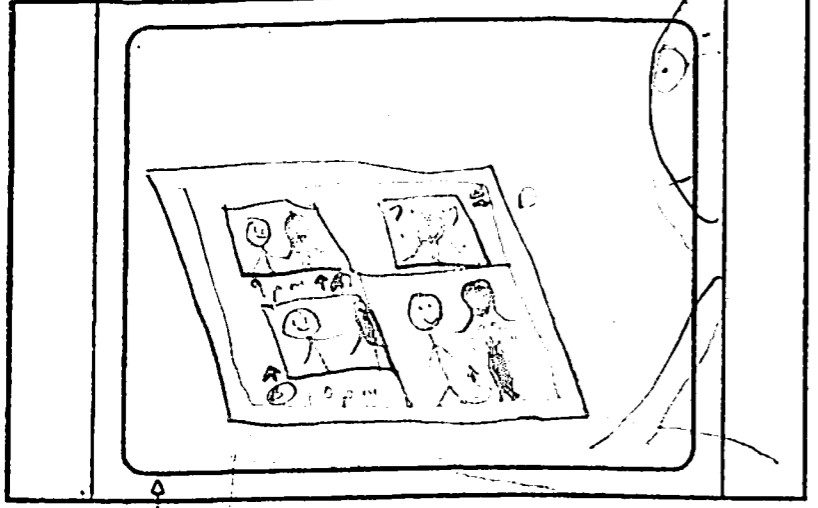

1:33 TV Safe LOCATION: DAY NIGHT OTHER 1:66

ACTION
Ellen moves Q.C. mouse to off screen of mystery woman @ 9 pm then @ 10 pm then (C) then moves to (D) to the window.

DIAL
Ellen: It wouldn't give me any satisfaction to prove you're lying.

SLG

TRANS

cut
SC. PANEL BG.

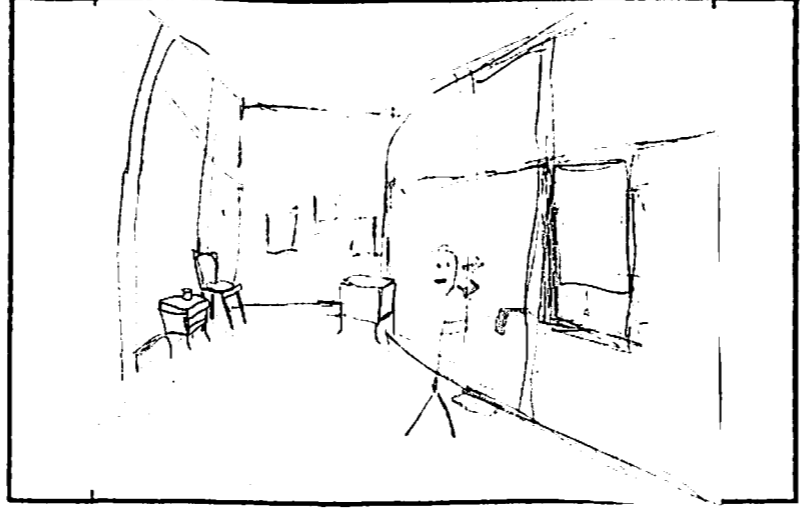

LOCATION: DAY NIGHT OTHER

ACTION
Bill looks relieved, but he nods with concern toward the window.

DIAL
Ellen (OS): ...and let it stay like that.

SLG

TRANS

cut
SC. PANEL BG. PAGE _____

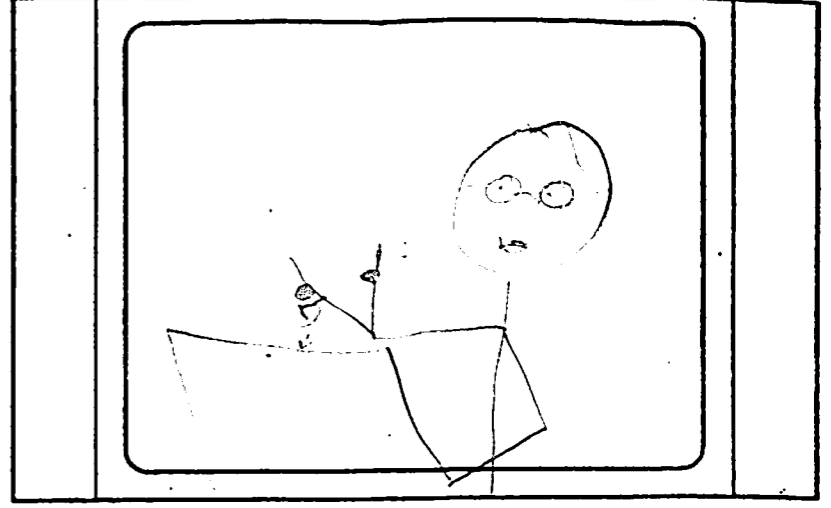

LOCATION: DAY NIGHT OTHER

ACTION
Ellen holds up a finger, then flourishes her finger.

DIAL
Ellen: I have something to show you. It made...

SLG *ing director*

TRANS *ation*

cut
SC.

PANEL

BG.

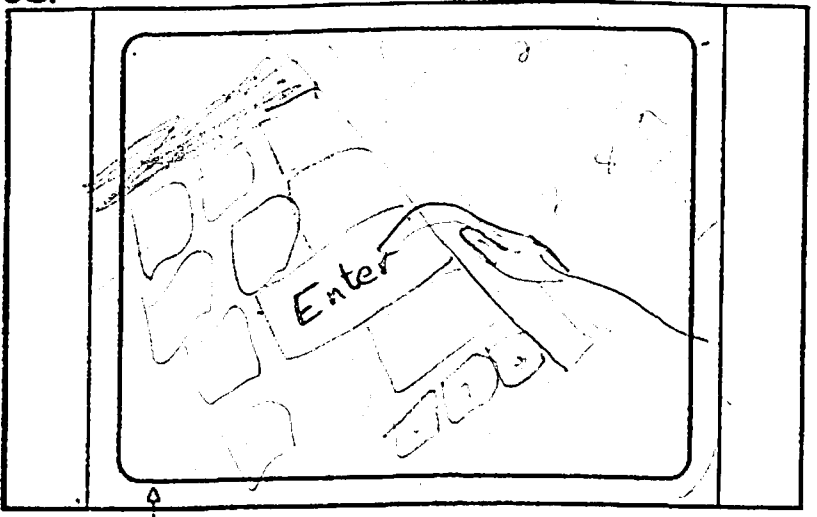

1:33 TV Safe 1:66
LOCATION:
DAY NIGHT OTHER

ACTION
Ellen presses the enter button.

DIAL
Ellen: this while you were out last night.

SLG

TRANS

cut
SC.

PANEL

BG.

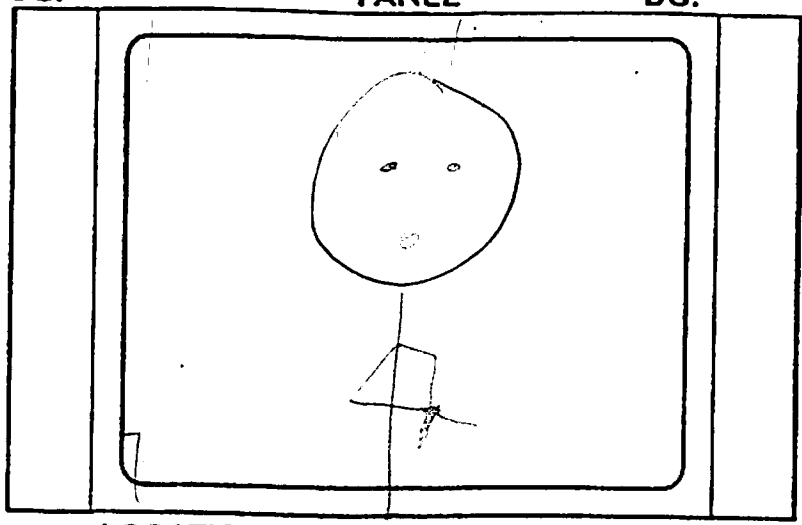

LOCATION:
DAY NIGHT OTHER

ACTION
Light shines on Milt, he seems surprised and intimidated.

DIAL

SLG

TRANS

cut
SC.

PANEL

BG.



LOCATION:
DAY NIGHT OTHER

ACTION
Men creep out of the shadows and shine out the windows. One man in a trench coat walks.

DIAL
Ellen (O.S.): Let me explain to you

SLG
Director

TRANS
ation

cut

SC.

PANEL

BG.

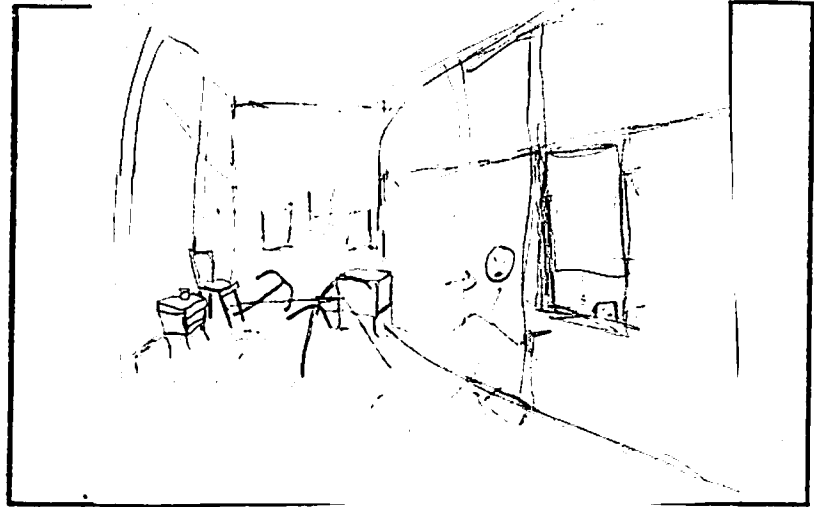

1:33 TV Safe LOCATION: DAY NIGHT OTHER 1:66

ACTION Grappling hooks shoot out from (S.S.) Milt jumps out of the way.

DIAL (S.S.): these black vertical lines divide.

SLG

TRANS

SC. cont

PANEL

BG.

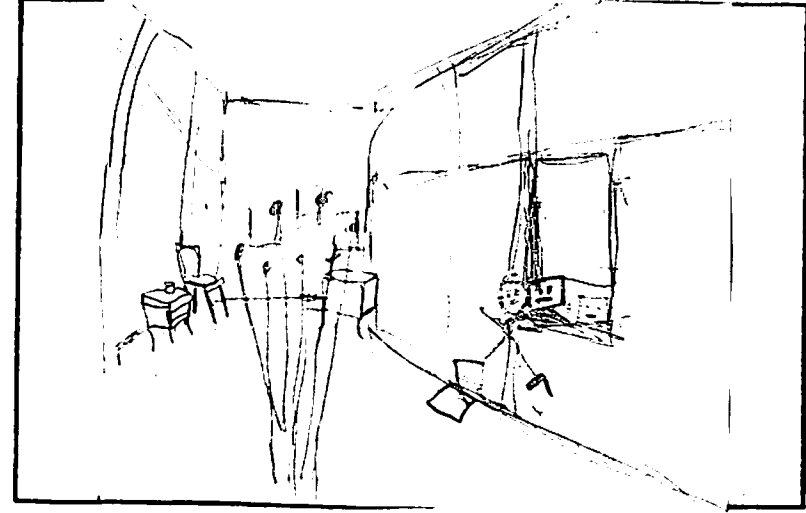

LOCATION: DAY NIGHT OTHER

ACTION Hooks hit the wall. Minion gets his arms around Milt's neck. Milt drops his gun

DIAL EI (O.S.): our five years of marriage

SLG

TRANS

cut

SC.

PANEL

BG.

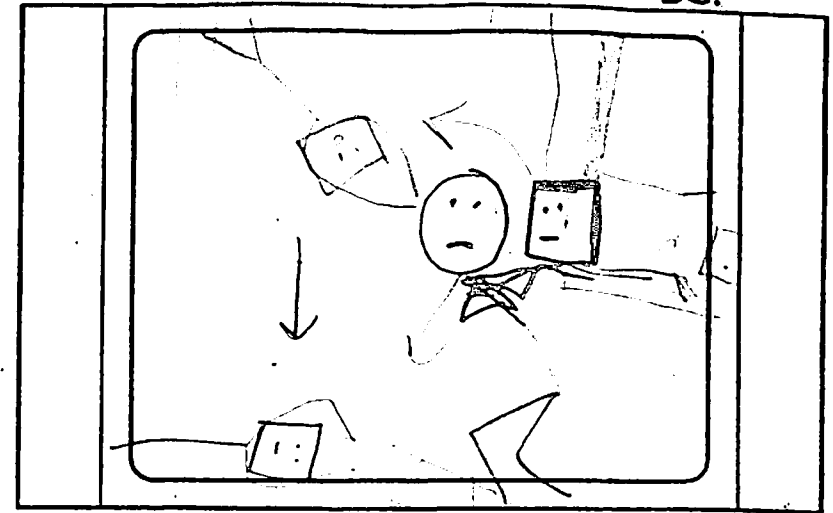

LOCATION: DAY NIGHT OTHER

ACTION Milt strains and bends, flipping minion over him.

DIAL EI (O.S.): into mouths.

SLG ...ing director

TRANS /ation

SC. cont

PANEL

BG.

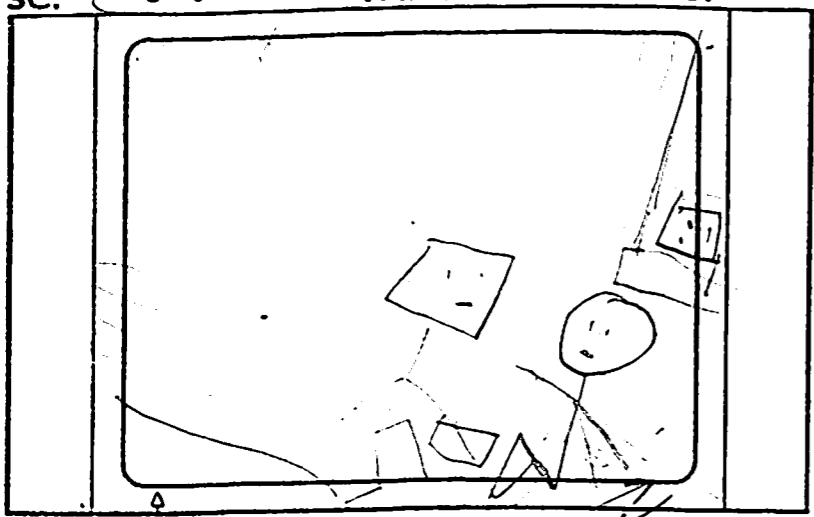

1:33 TV Safe LOCATION: DAY NIGHT OTHER 1:66

ACTION
Milt moves his head around
and looks at the screen
stand.

DIAL
Ellen (O.S.): These blue vertical
lines...

SLG

TRANS

cut

SC.

PANEL

BG.

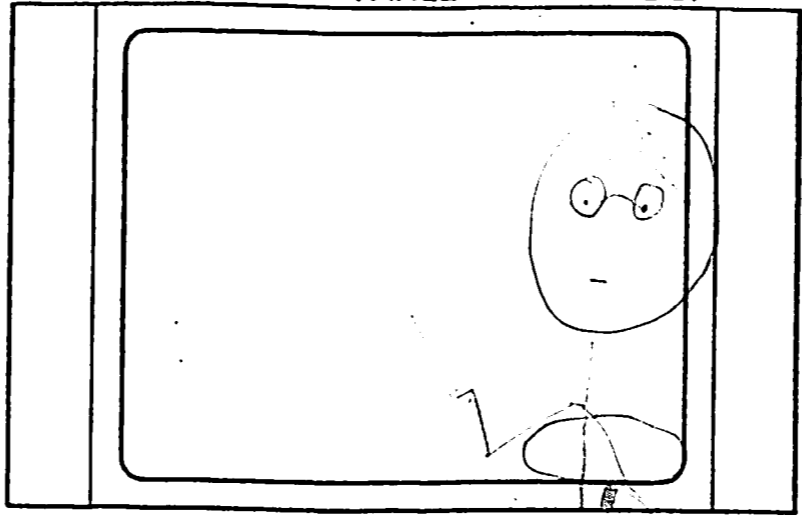

LOCATION:
DAY NIGHT OTHER

ACTION
Ellen (O.S.) has heard and
has...

DIAL

SLG

TRANS

SC.

PANEL

BG.

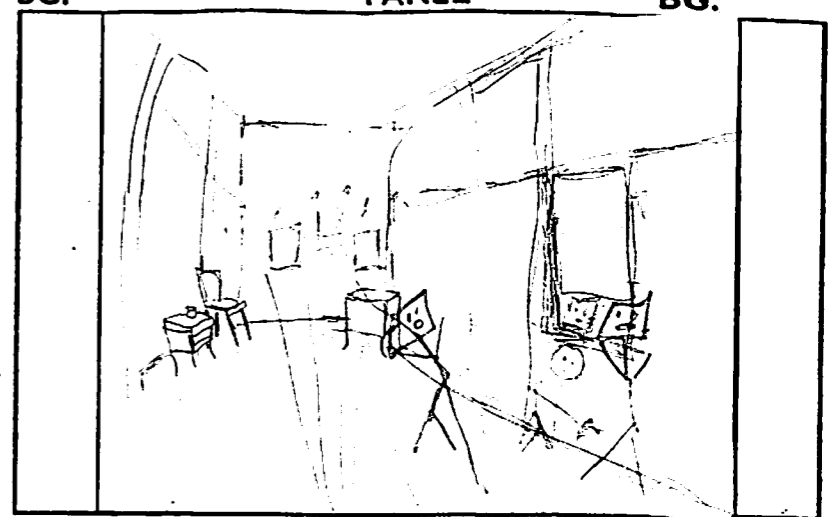

LOCATION:
DAY NIGHT OTHER

ACTION
A blue laser shoots out,
and... One
has climbed...
Milt reaches his gun.

DIAL
Ellen (O.S.): divide the monitor into
weeks.

SLG
...ing director

TRANSlation

cut

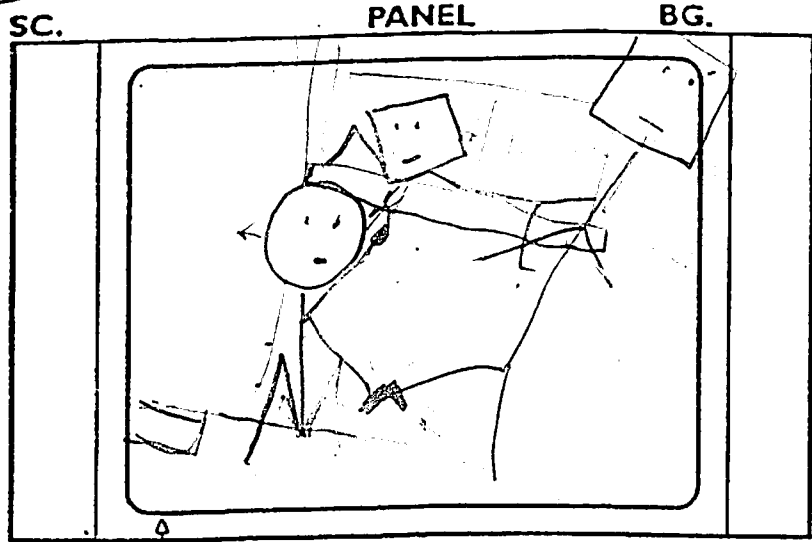

1:33 TV Safe LOCATION: DAY NIGHT OTHER 1:66

ACTION

Ellen is trying to hold off
 the camera through a doorway
 and is holding her head
 against the wall.

DIAL

Ellen (O.S.): Now. Each one hits
 red horizontal line

SLG

TRANS

cut

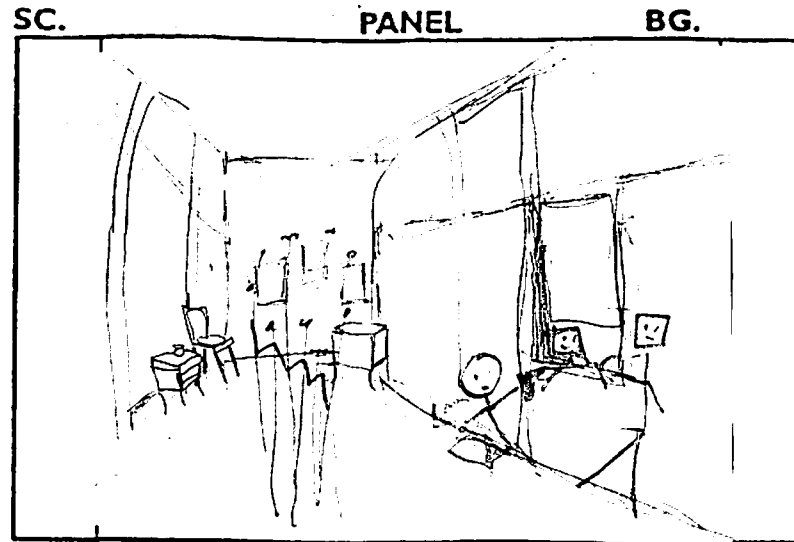

LOCATION: DAY NIGHT OTHER

ACTION

Ellen is pushed back to the
 ground by means of red
 and blue laser beams
 and is grappled.

DIAL

Ellen (O.S.): running across the top
 of the graph

SLG

TRANS

cut

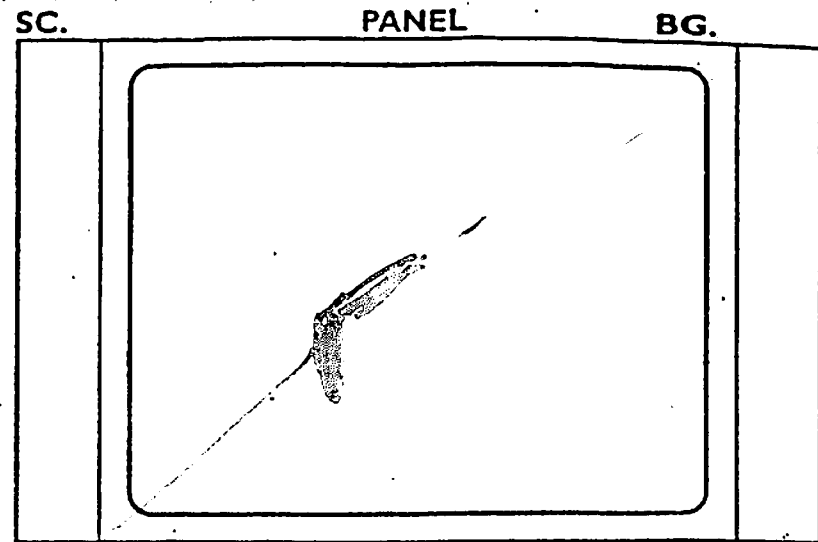

LOCATION: DAY NIGHT OTHER

ACTION

Gun (SFX) hits
 Gun < fire > twice.

DIAL

Ellen (SFX) hits the blue
 vertical line,

SLG

Ellen (SFX) director

TRANS

Ellen (SFX) director

cut

SC. PANEL BG.



1:33 TV Safe LOCATION: DAY NIGHT OTHER 1:66

ACTION Dead minion falls out the window, but we are ready.

DIAL on (O.S.D), that indicates the number of

SLG

TRANS

cut

SC. PANEL BG.

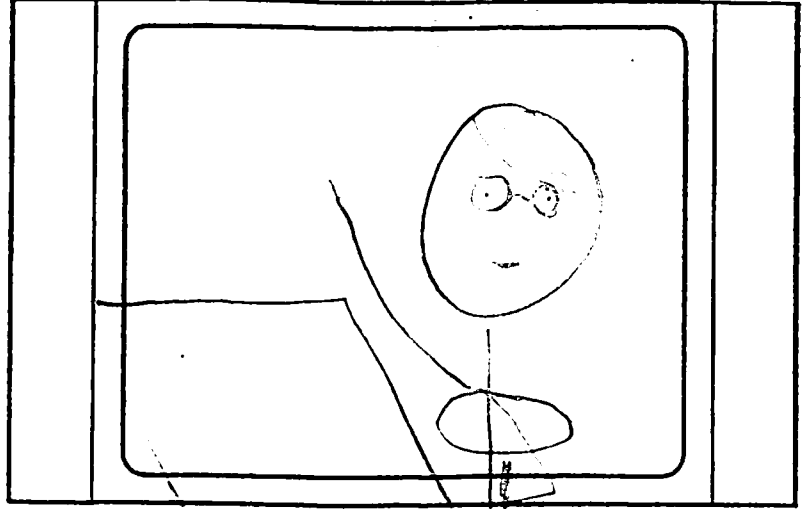

LOCATION: DAY NIGHT OTHER

ACTION Ellen waves her hand at the character in front of her.

DIAL sexual experiences over a seven-day period.

SLG

TRANS

cut

SC. PANEL BG.

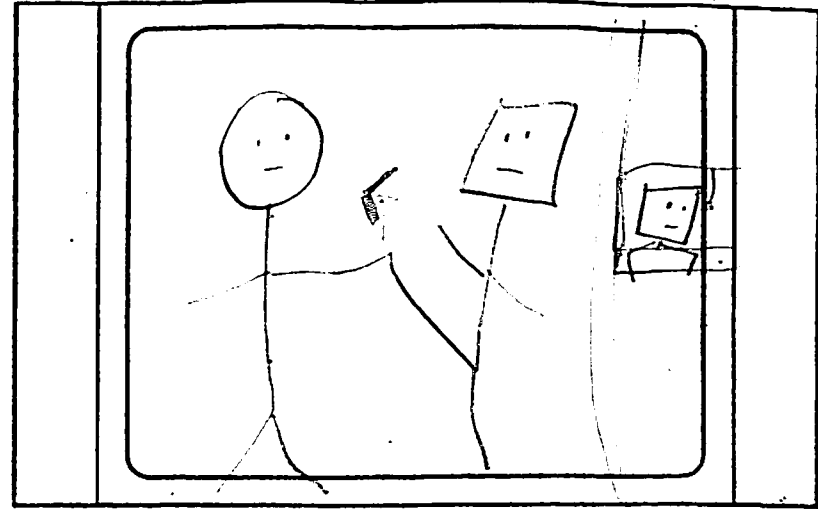

LOCATION: DAY NIGHT OTHER

ACTION Minion kicks Milt's gun out of his hand

DIAL Milt: Ellen, for God's sake...

SLG ...ing director

TRANS / action

SC. *cont* PANEL BG.

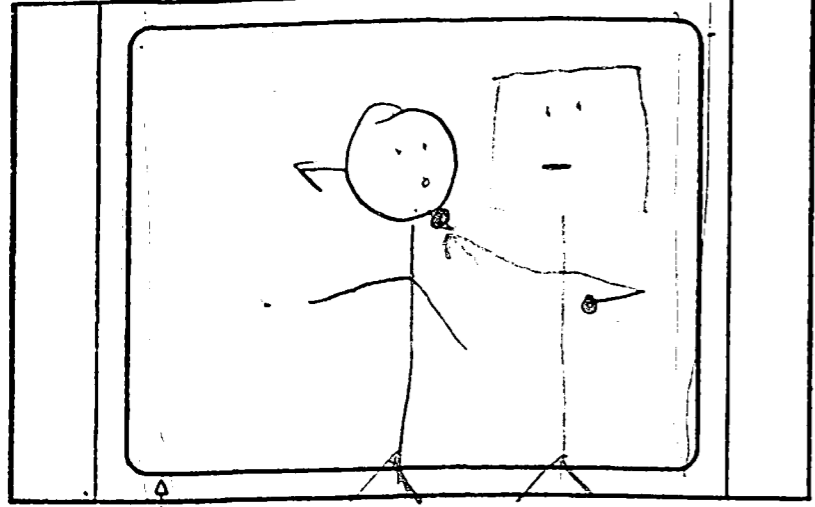

1:33 TV Safe LOCATION: DAY NIGHT OTHER 1:66

ACTION
Milton punches Milt, who
starts to yell.

DIAL
Milt: we can talk about
this later.

SLG

TRANS

SC. *cont* PANEL BG.

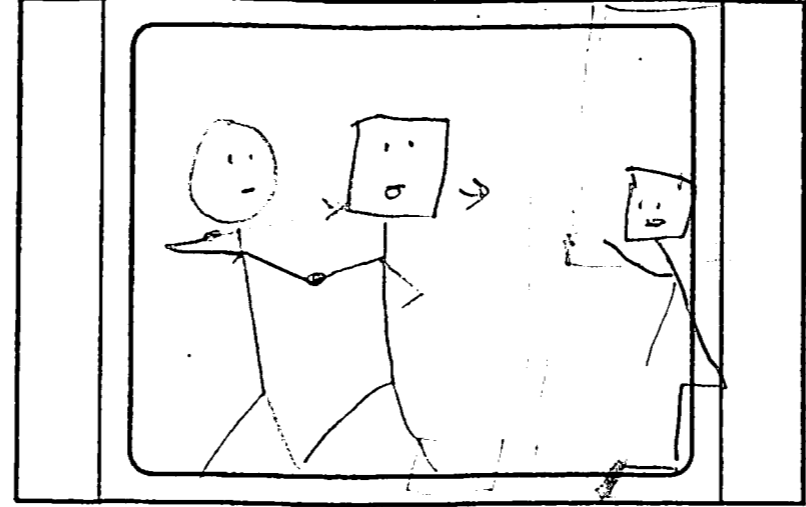

LOCATION: DAY NIGHT OTHER

ACTION
Milt blocks Milton's punch
and looks for a way
out. And Milton is getting
angry.

DIAL
this later,
Milton: You're always saying
later.

SLG

TRANS

SC. *cont* PANEL BG.

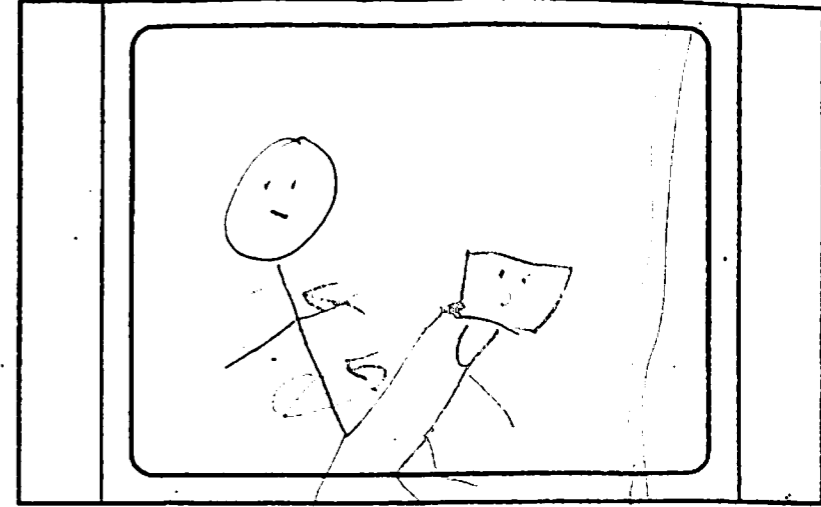

LOCATION: DAY NIGHT OTHER

ACTION
Milt spins & kicks in
Milton

DIAL
Milton: You're always saying
later.

SLG *reg director*

TRANS *action*

cut

SC. PANEL BG.

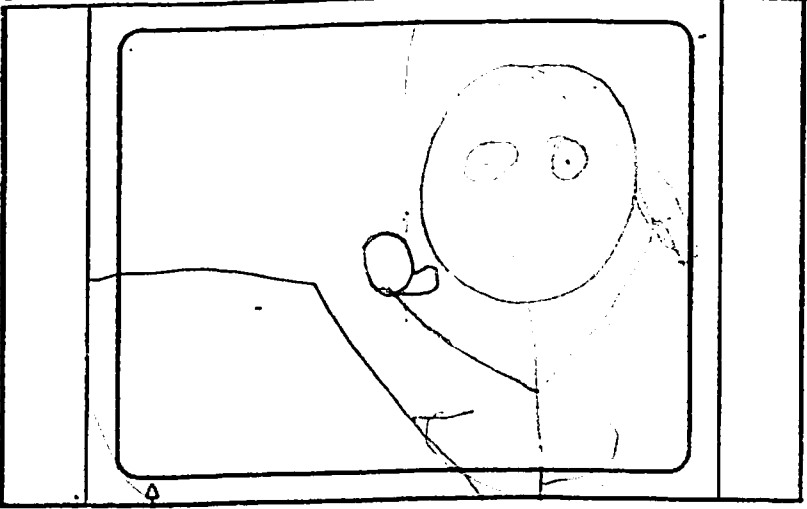

1:33 TV Safe LOCATION: DAY NIGHT OTHER 1:66

ACTION
Ellen plays with her hair while looking in a compact.

DIAL
Ellen: That's a favorite play of my ours.

SLG

TRANS

SC. *cont* PANEL BG.

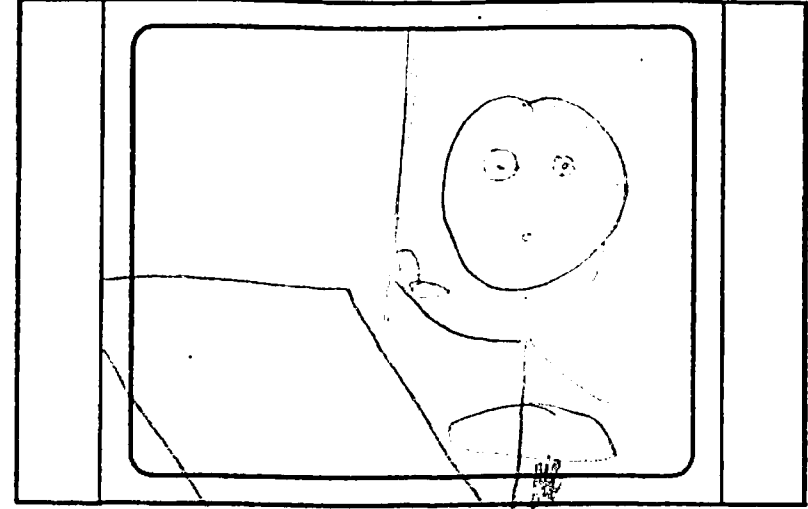

LOCATION: DAY NIGHT OTHER

ACTION
Ellen looks up, alarmed by what she sees O.S.

DIAL
Ellen: No, Mitt.

SLG

TRANS

SC. *cont* PANEL BG.

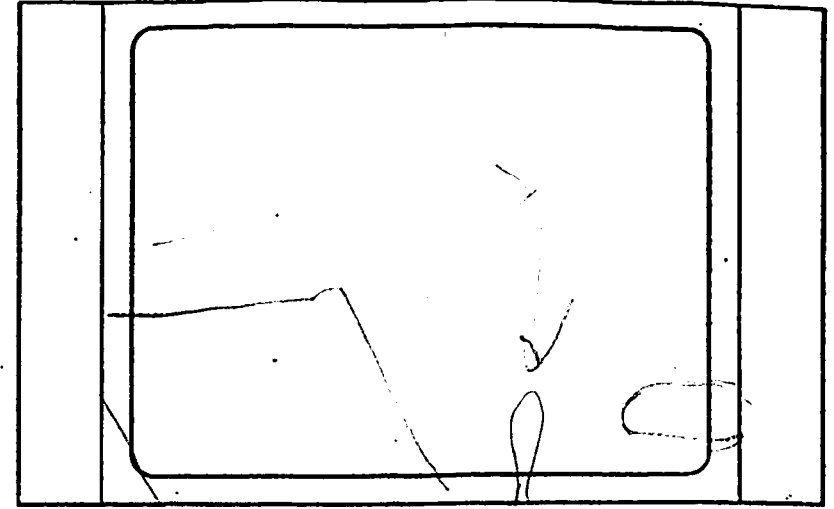

LOCATION: DAY NIGHT OTHER

ACTION
Ellen ducks out of frame as a shot *clings* above her.

DIAL
Ellen: Not tonight.

SLG *ing director*

TRANS *ation*

SC. cont PANEL BG.

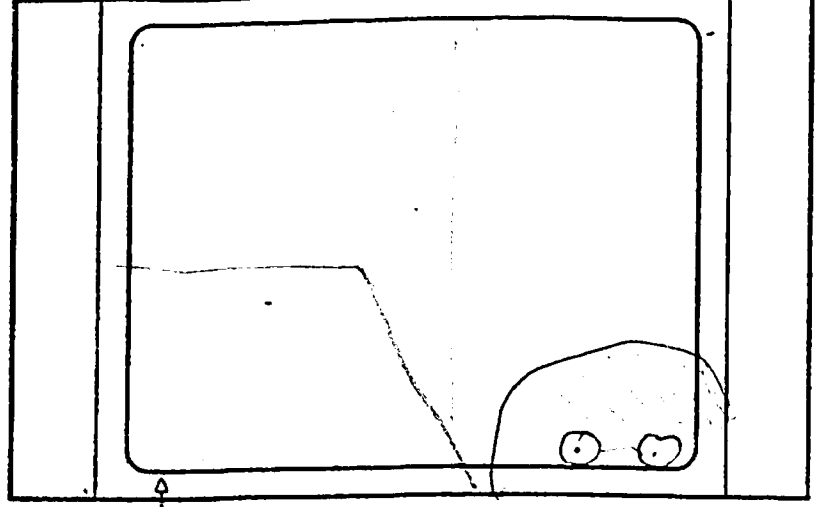

1:33 TV Safe LOCATION: DAY NIGHT OTHER 1:66

ACTION
Ellen peeks up into frame

DIAL
Ellen: [inaudible] while they [inaudible]

SLG

TRANS

SC. PANEL BG.

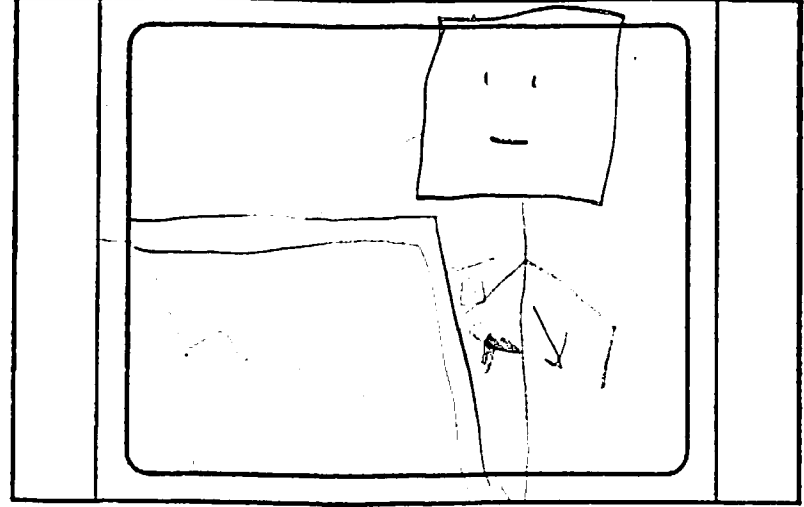

LOCATION: DAY NIGHT OTHER

ACTION
POV Ellen in mirror room

DIAL
Ellen (OS): I'd like to continue

SLG

TRANS

SC. cont PANEL BG. PAGE

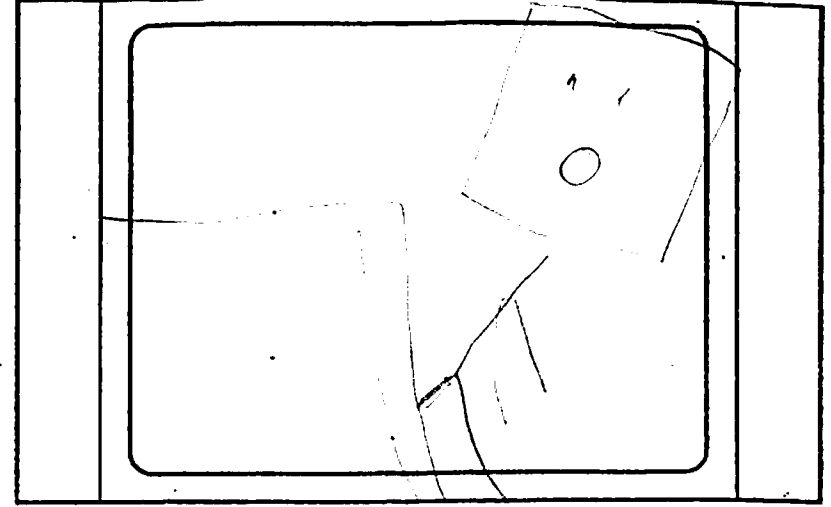

LOCATION: DAY NIGHT OTHER

ACTION
A laser beam shoots from the side.

DIAL
[inaudible]

SLG
[inaudible] director

TRANS
[inaudible]

cut
SC. PANEL BG.



1:33 TV Safe LOCATION: DAY NIGHT OTHER 1:66

ACTION
Lasers shoot out of the compact and a laser beam leads on.

DIAL
Ellen (O.S.): Now.

SLG

TRANS

cut
SC. PANEL BG.

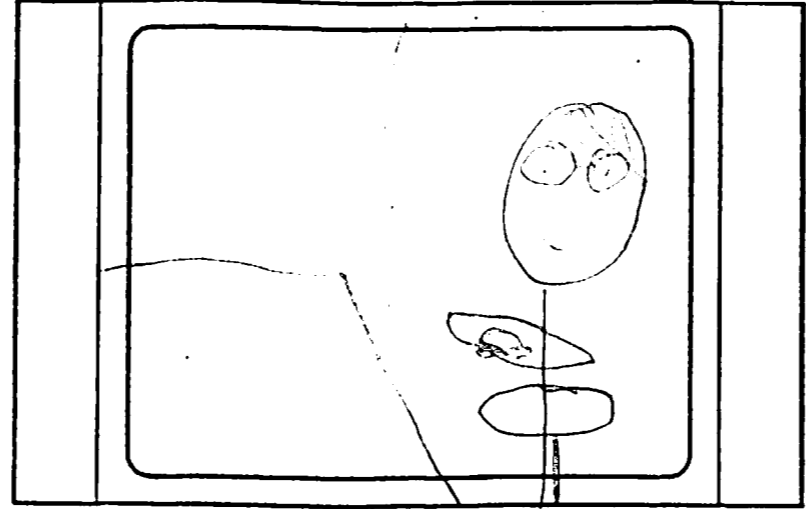

LOCATION: DAY NIGHT OTHER

ACTION
The character ducks into a hole.

DIAL
You'll notice on this graph

SLG

TRANS

cut
SC. PANEL BG. PAGE _____

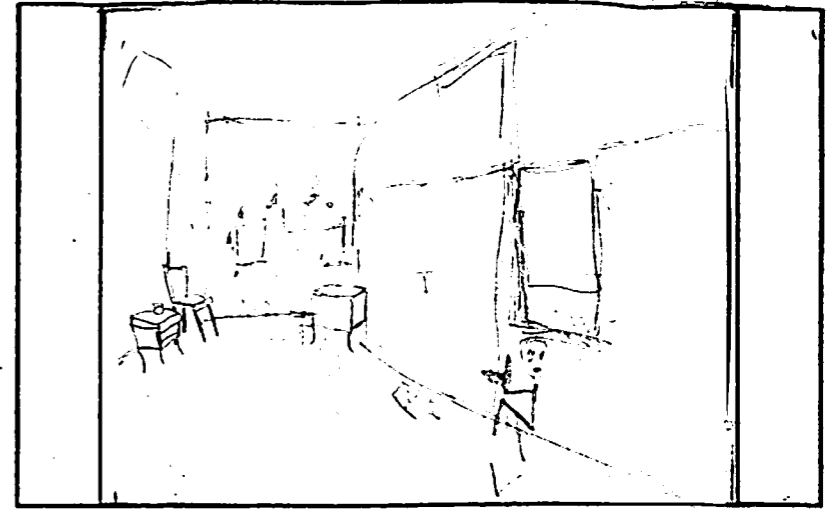

LOCATION: DAY NIGHT OTHER

ACTION
The character is looking at the graph.

DIAL
The character is speaking of our program.

SLG
The director

TRANS
ation

cut

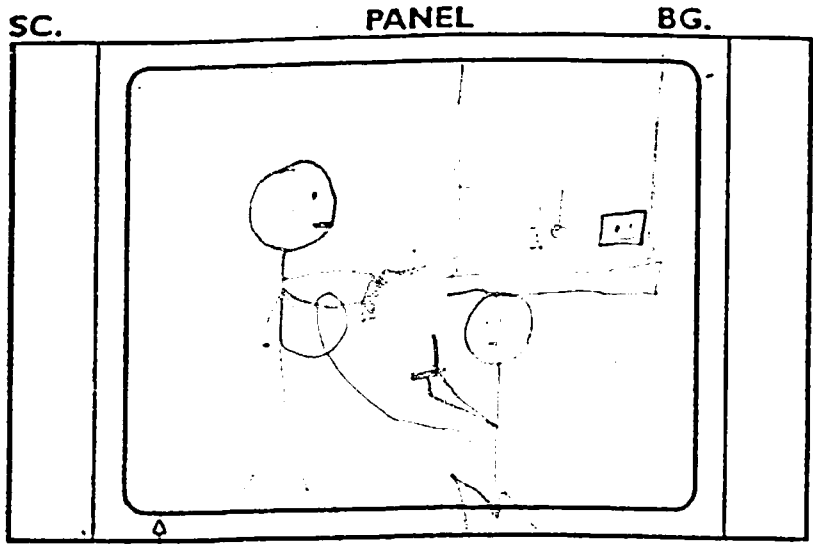

Δ 1:33 TV Safe LOCATION: DAY NIGHT OTHER Δ 1:66

ACTION
Milt [unclear] and [unclear]

DIAL
Ellen (OS): Louche, the [unclear] [unclear] [unclear]

SLG

TRANS

cut

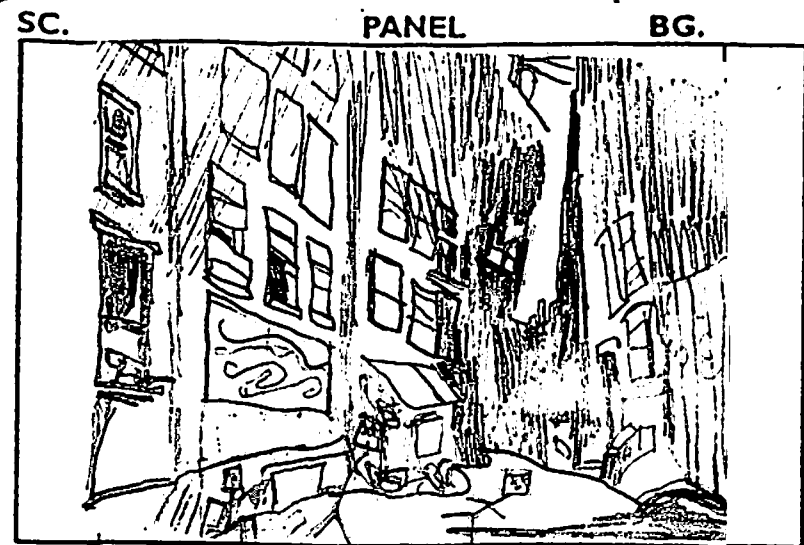

LOCATION: DAY NIGHT OTHER

ACTION
Milt SFX! shoots, taking down a second guy!

DIAL
Ellen (OS): Louche, I'm [unclear] a week,

SLG

TRANS

cut

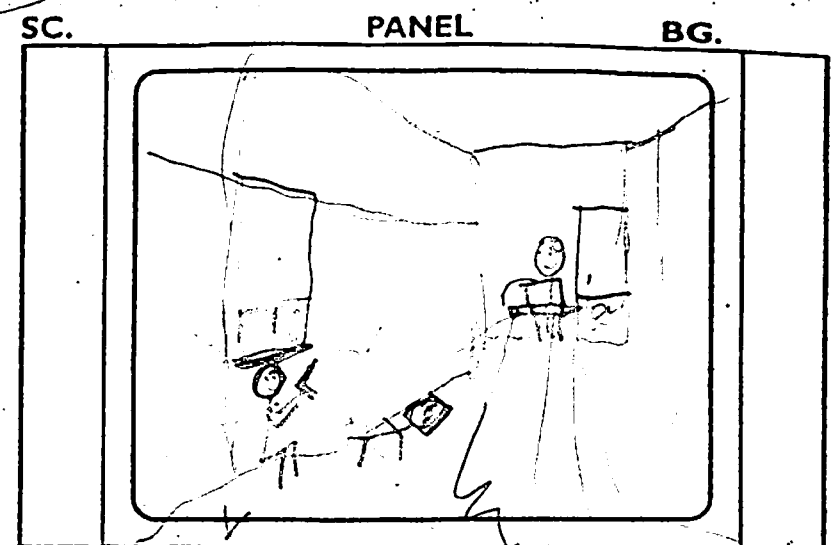

LOCATION: DAY NIGHT OTHER

ACTION
Ellen continues on [unclear] [unclear] [unclear]

DIAL
and now, gradually, to [unclear] [unclear] become [unclear]

SLG [unclear] director

TRANS /ation

cut

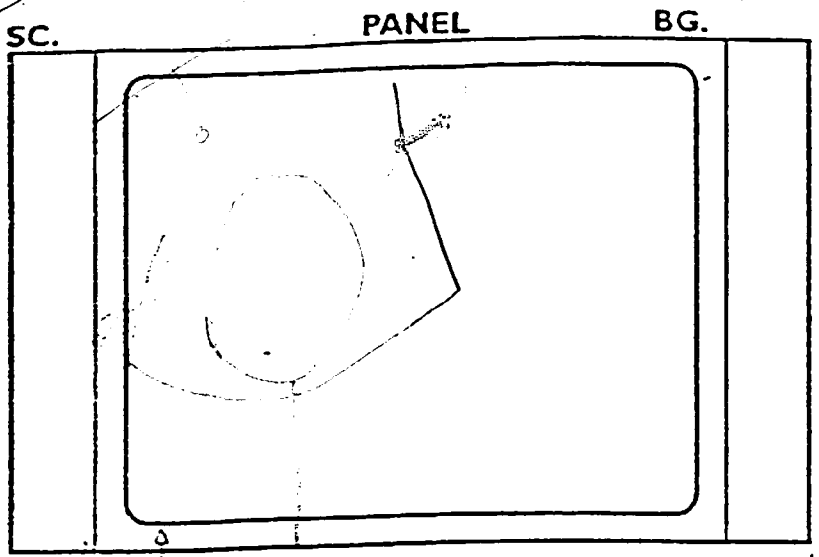

1:33 TV Safe 1:66
 LOCATION: DAY NIGHT OTHER

ACTION
 Milt [unclear] [unclear]

DIAL
 When (O.S.) [unclear] [unclear] [unclear]

SLG

TRANS

cut

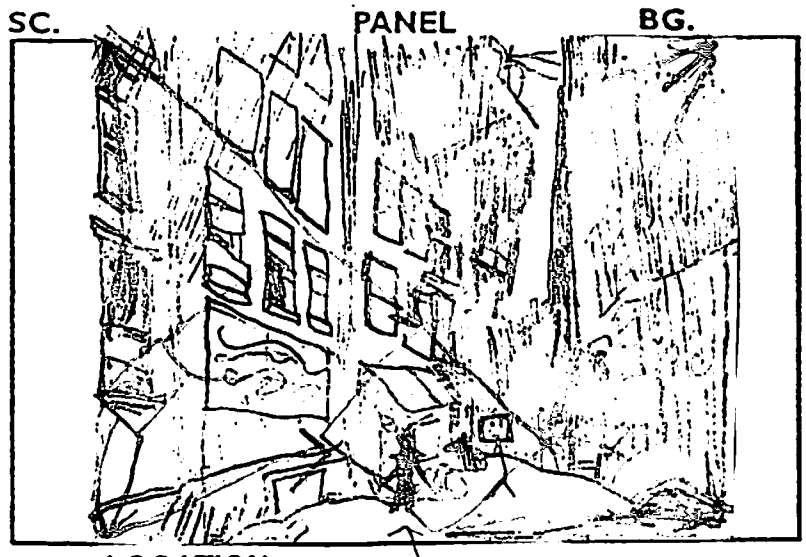

LOCATION: DAY NIGHT OTHER

ACTION
 [unclear] [unclear] [unclear] [unclear] [unclear]

DIAL
 [unclear] [unclear] [unclear]

SLG

TRANS

cut

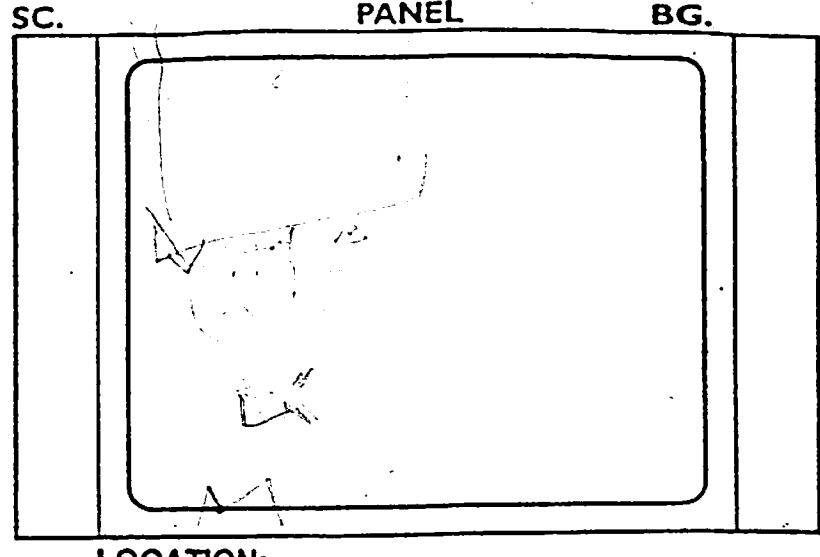

LOCATION: DAY NIGHT OTHER

ACTION
 Milt looks upset [unclear] [unclear]

DIAL
 The night of your sister's wedding

SLG [unclear] director

TRANS [unclear] [unclear]

SC. PANEL BG.

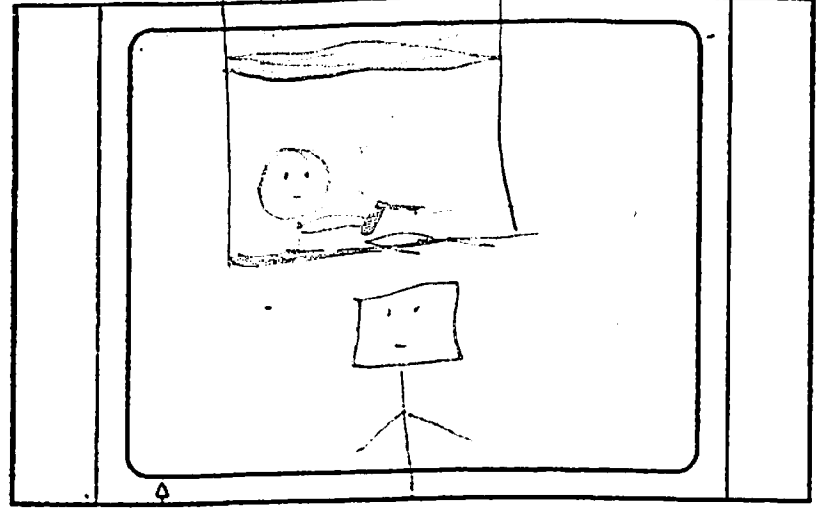

1:33 TV Safe LOCATION: DAY NIGHT OTHER 1:66

ACTION
Ellen is in the window and she is looking out.

DIAL
Ellen: I don't know where he is.

SLG

TRANS

cut
SC. PANEL BG.

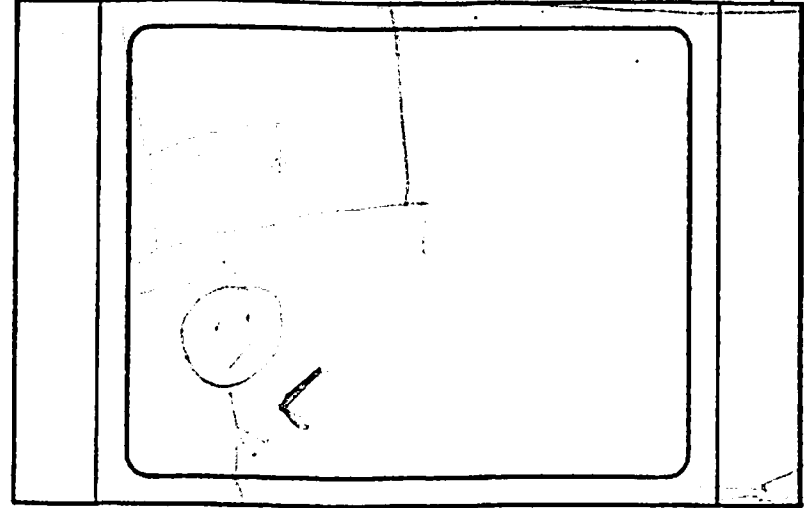

LOCATION: DAY NIGHT OTHER

ACTION
Ellen is in the window and she is looking out.

DIAL
Ellen: I don't know where he is.

SLG

TRANS

SC. PANEL BG.

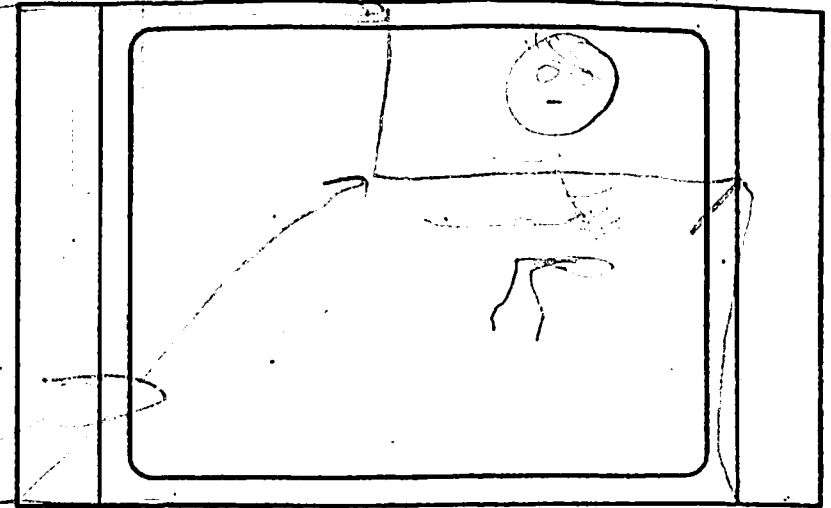

LOCATION: DAY NIGHT OTHER

ACTION
Ellen is in the window and she is looking out.

DIAL
Ellen: I don't know where he is.

SLG *Ellen is the director*

TRANS *action*

cut

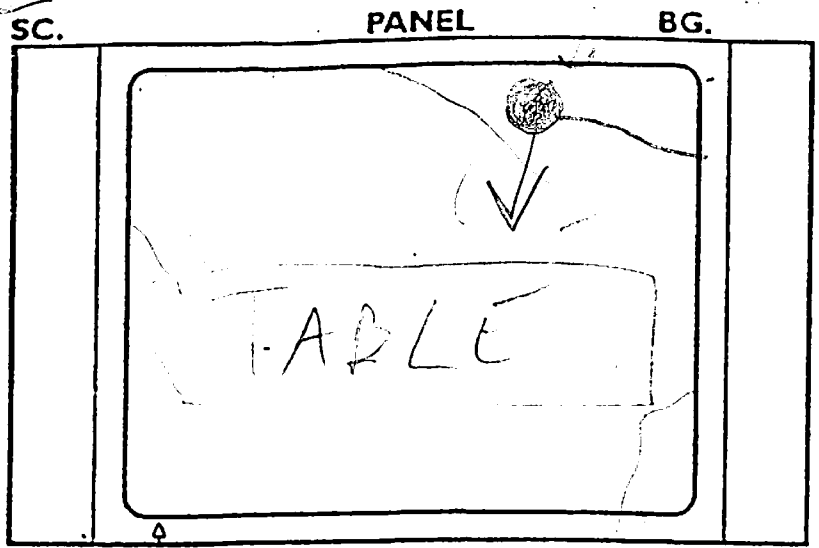

1:33 TV Safe LOCATION: DAY NIGHT OTHER 1:66

ACTION
Ellen starts keyboard on the table, laptop.

DIAL
Ellen (to Milt): Not much.

SLG

TRANS

cut

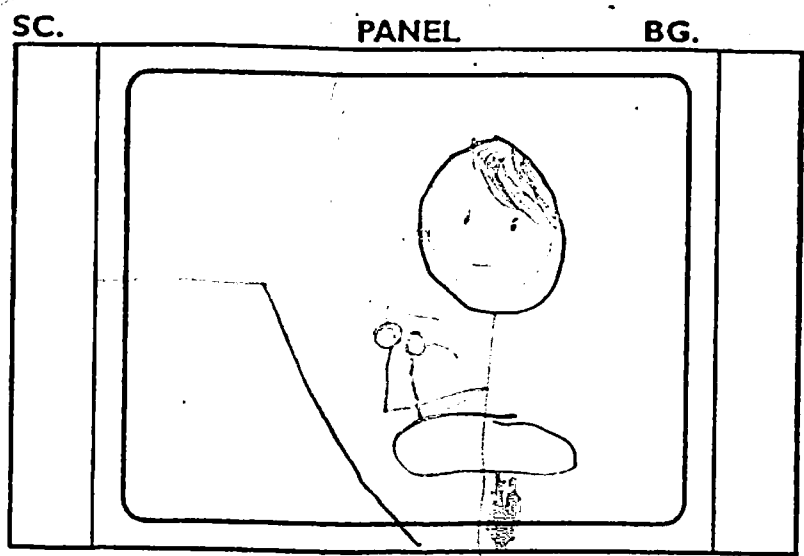

LOCATION: DAY NIGHT OTHER

ACTION
Ellen takes off glasses and looks at her laptop screen.

DIAL
Ellen: I have nothing further to say...

SLG

TRANS

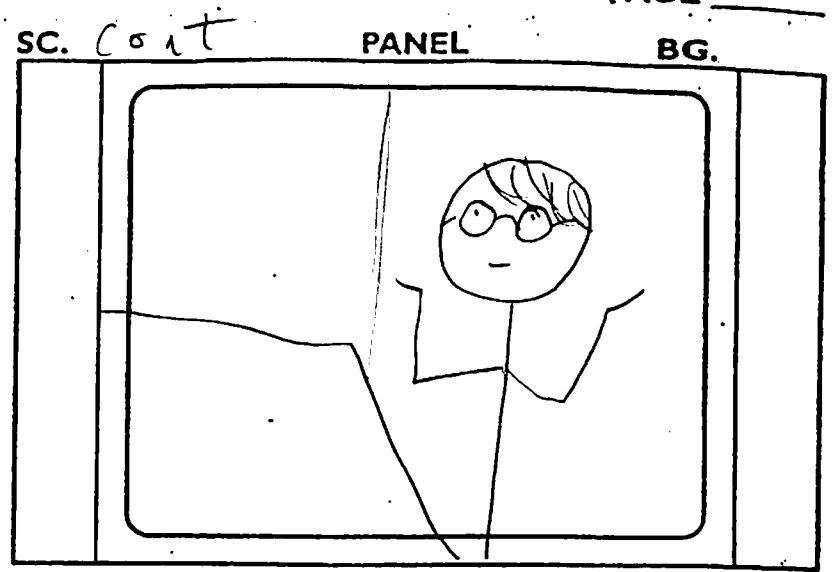

LOCATION: DAY NIGHT OTHER

ACTION
Ellen throws up her hands in frustration.

DIAL
Milt.

SLG *ing director*

TRANS *ation*

cut

SC.

PANEL

BGG.

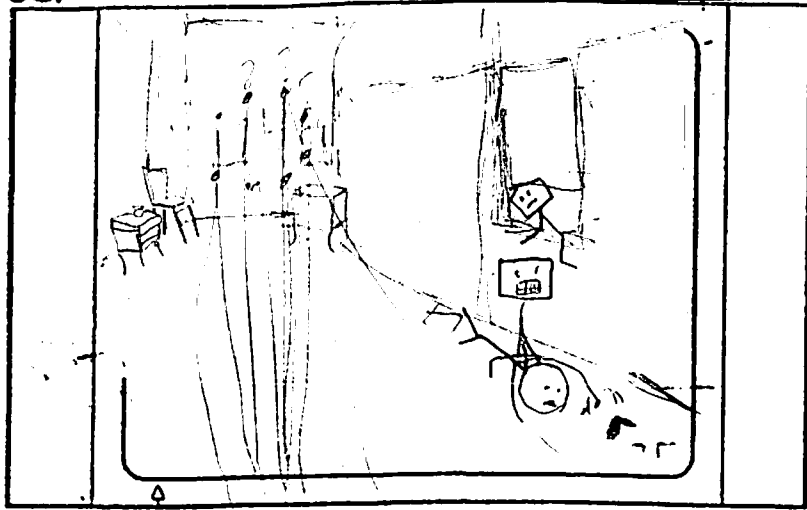

1:33

TV Safe

LOCATION:

DAY

NIGHT

OTHER

1:66

ACTION

Minion is strangling Mitt, who's trying to reach the gun.

DIAL

Ellen (O.S.): When something like this is allowed to happen

SLG

TRANS

SC. cont

PANEL

BG.

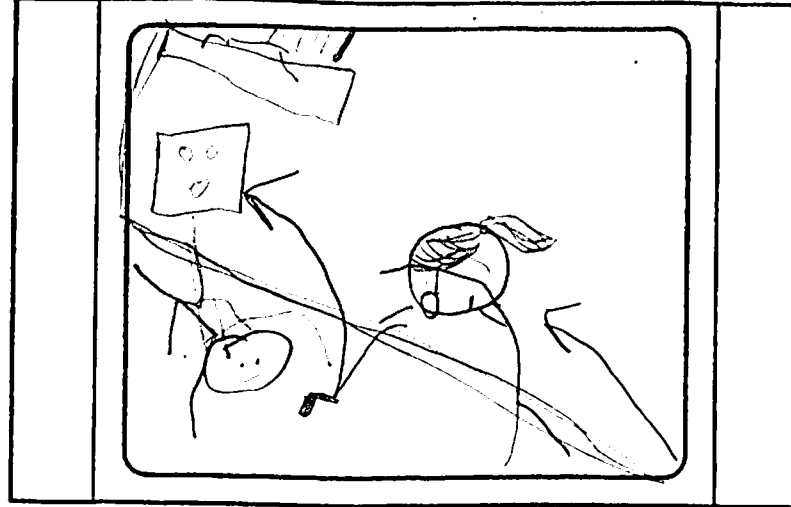

LOCATION:

DAY

NIGHT

OTHER

ACTION

Ellen does some mean flipping + plows into minion

DIAL

SLG

TRANS

PAGE

SC. cont

PANEL

BG.

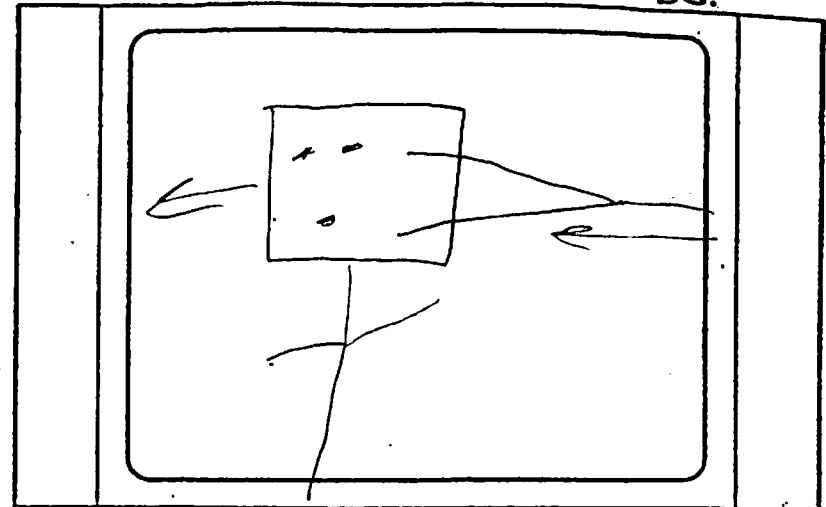

LOCATION:

DAY

NIGHT

OTHER

ACTION

Minion gets Ellen's feet in his face.

DIAL

SLG

TRANS lation

cut

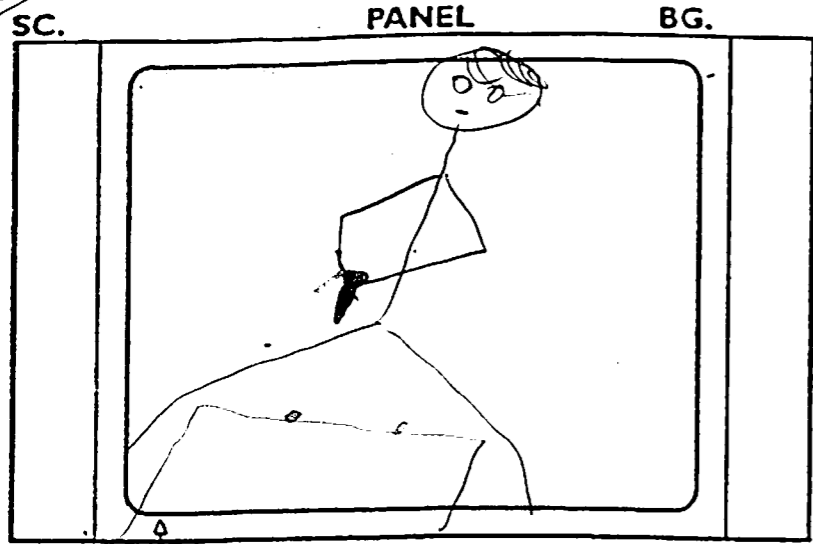

1:33 TV Safe LOCATION: DAY NIGHT OTHER 1:66

ACTION
Ellen looms over minion and
SFX: (shoots).

DIAL
Ellen: in a marriage, you can't
go on pretending.

SLG

TRANS

cut

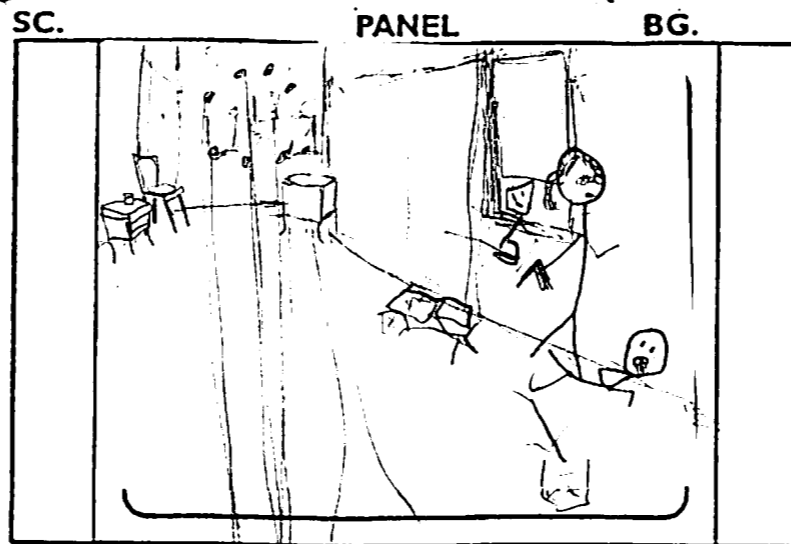

LOCATION:
DAY NIGHT OTHER

ACTION
Ellen moves back to Milt, who's
clutching his throat from being
strangled

DIAL
You want to pretend.

SLG

TRANS

cut

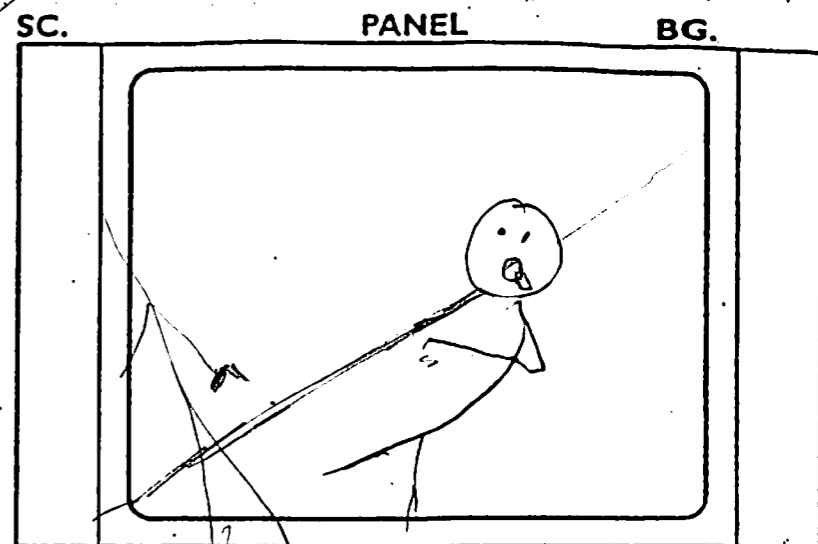

LOCATION:
DAY NIGHT OTHER

ACTION
Milt (SFX: coughs), while
pointing urgently toward Ellen

DIAL
(Milt) Oh, the temptation is
great

SLG ...g director

TRANS lation

cut
SC.

PANEL

BG.

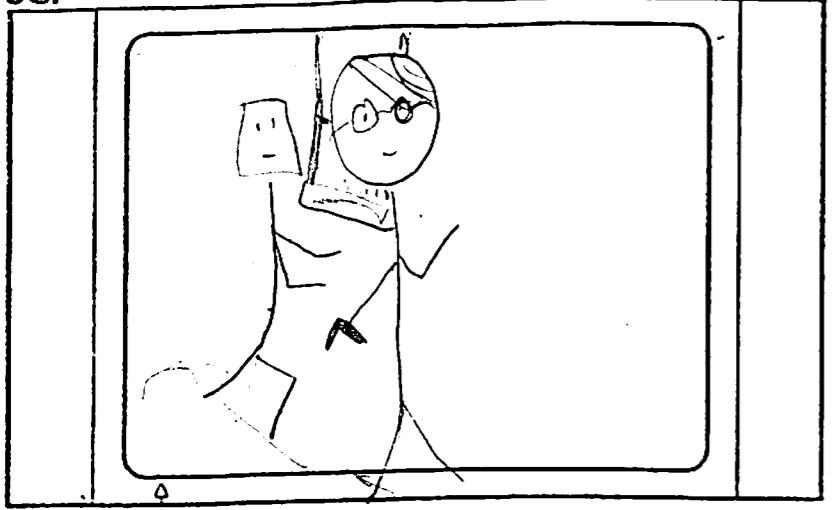

Δ 1:33 TV Safe LOCATION: DAY NIGHT OTHER Δ 1:66

ACTION
Milton is sneaking up behind Ellen.

DIAL
Ellen: to overlook, to find excuses

SLG

TRANS

cut
SC.

PANEL

BG.

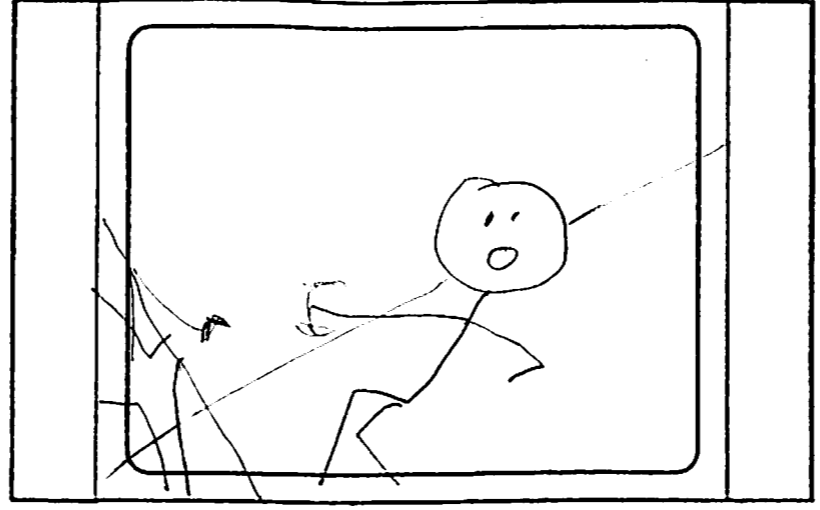

LOCATION: DAY NIGHT OTHER

ACTION
Milt continues waving behind Ellen as Milton sneaks in.

DIAL
Milt: to rationalize.

SLG

TRANS

SC. cont

PANEL

BG.

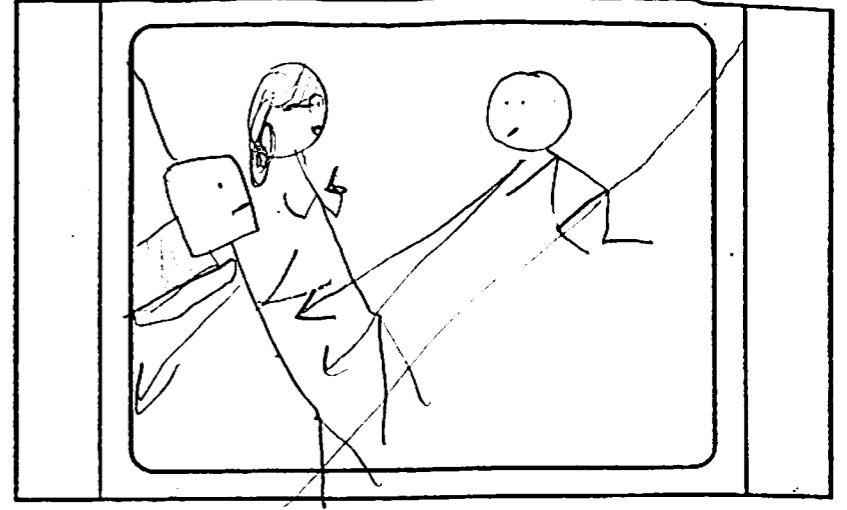

LOCATION: DAY NIGHT OTHER

ACTION
Milt lunges past Ellen and tackles Milton.

DIAL
But here, Milt

SLG
reg director

TRANS
lation

SC. cont

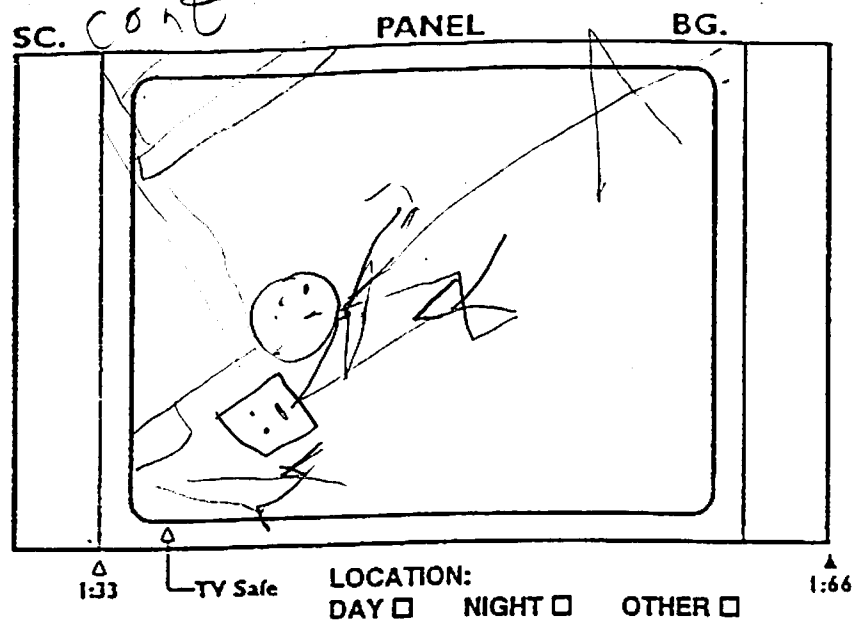

1:33 TV Safe 1:66

LOCATION: DAY NIGHT OTHER

ACTION
Milt waves o.s. Ellen away

DIAL

SLG

TRANS

cut

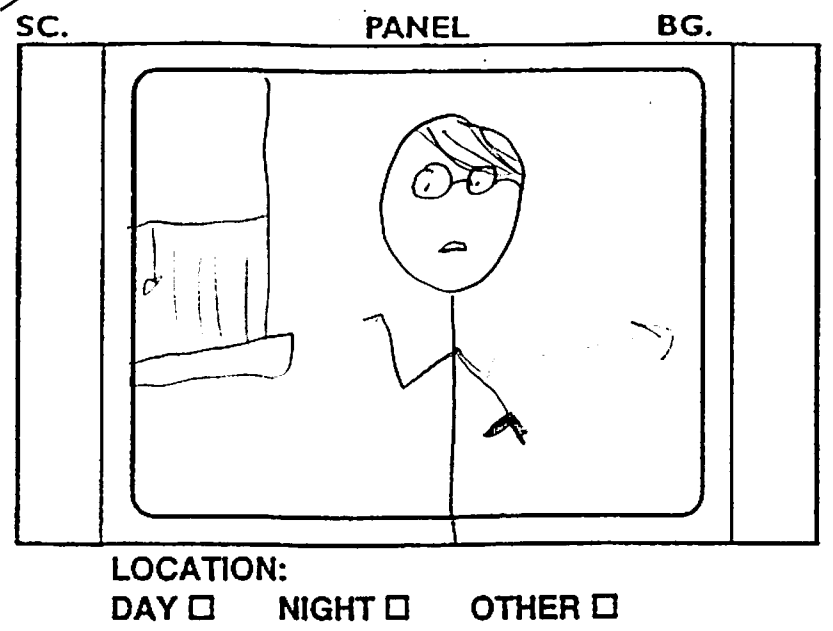

LOCATION: DAY NIGHT OTHER

ACTION
Ellen continues talking pointedly to Milt, then turns and walks off.

DIAL
Ellen: Here are the facts.

SLG

TRANS

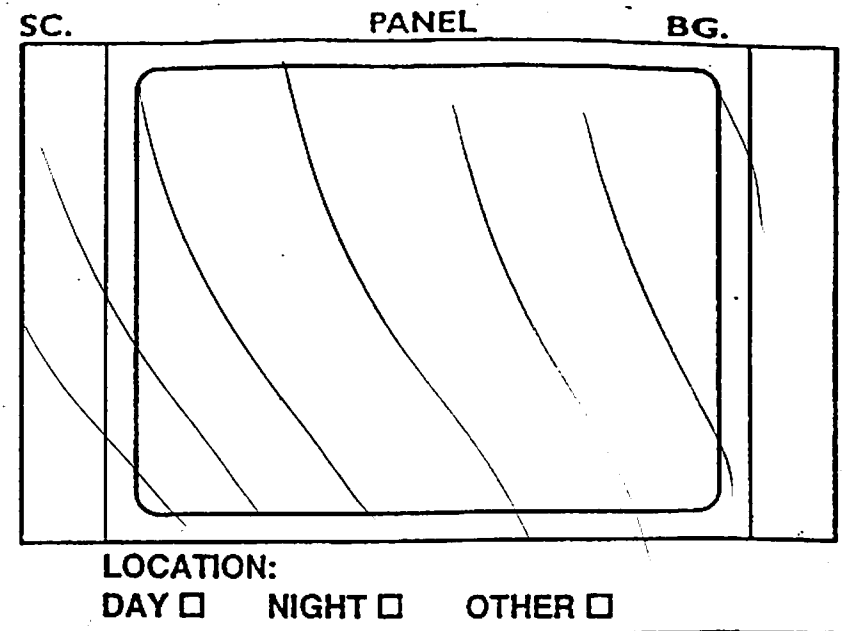

LOCATION: DAY NIGHT OTHER

ACTION

DIAL

SLG
ing director

TRANS
ation

cut

start

pan

stop

SC. PANEL BG.

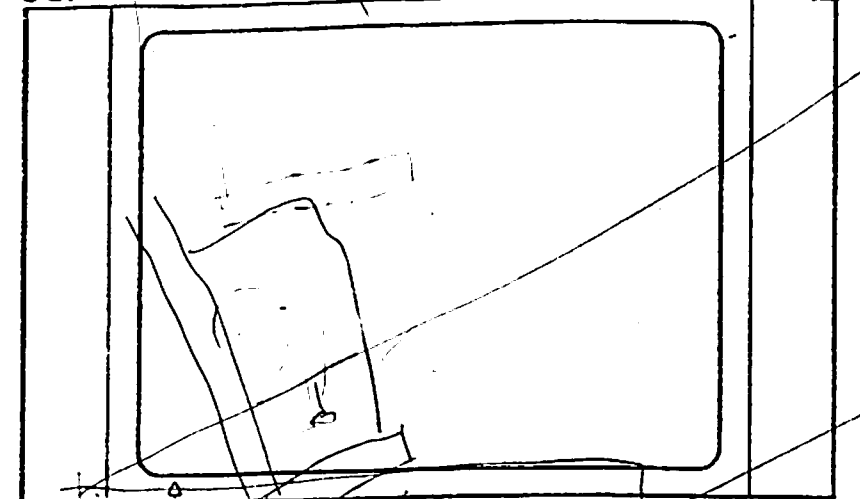

LOCATION: DAY NIGHT OTHER
TV Safe

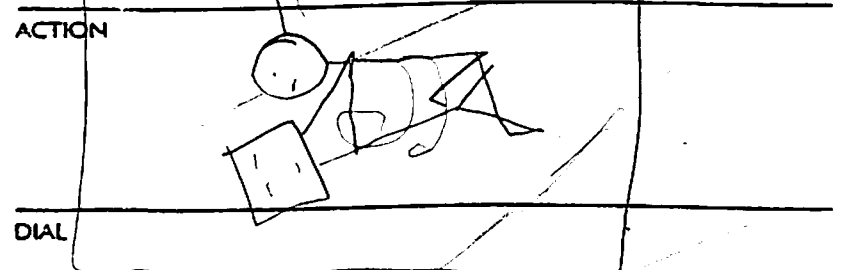

Milt (SFX: punches) minion, +
minion rolls over on
top

TRANS

SC. PANEL BG.

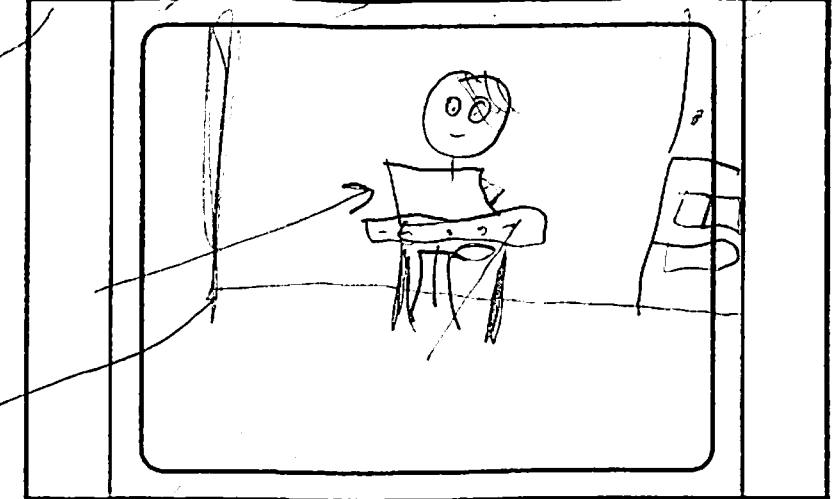

LOCATION: DAY NIGHT OTHER

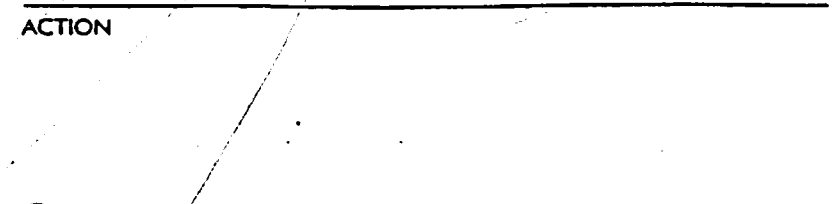

(DIAL)
Ellen moves to her laptop
Ellen: our relationship has
deteriorated to such
an

TRANS

cut

SC. PANEL BG.

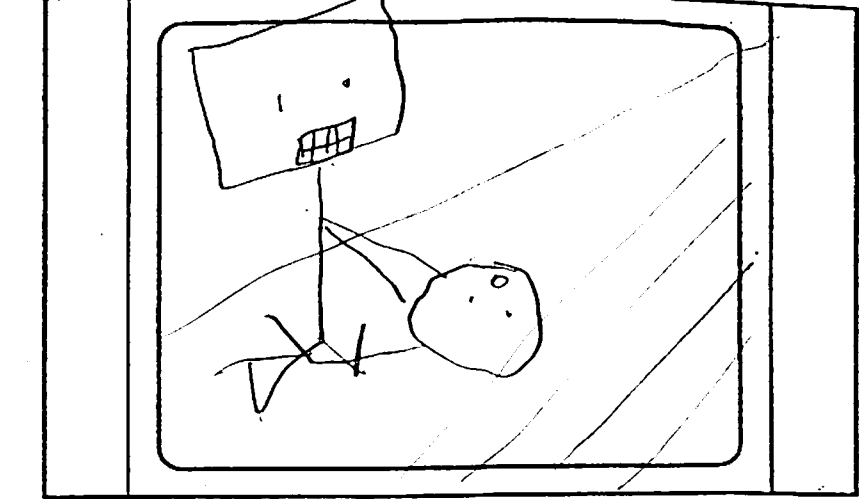

LOCATION: DAY NIGHT OTHER

ACTION
Minion is pushing Milt close
to a laser beam

(DIAL)
(OS):
extent that I don't
feel
director

TRANS lation

cat

SC. PANEL BG.

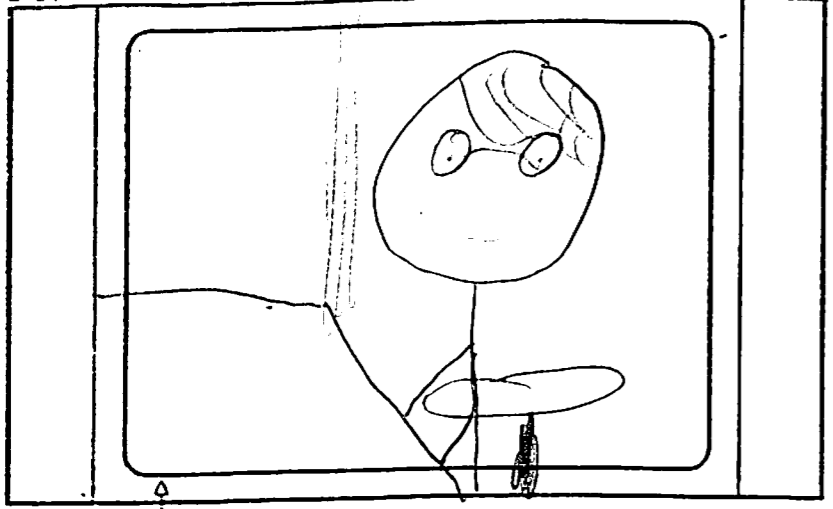

1:33 TV Safe LOCATION: DAY NIGHT OTHER 1:66

ACTION Ellen (SFX: types) furiously.

DIAL Ellen: responsible anymore for my own behavior.

SLG

TRANS

SC. cont PANEL BG.

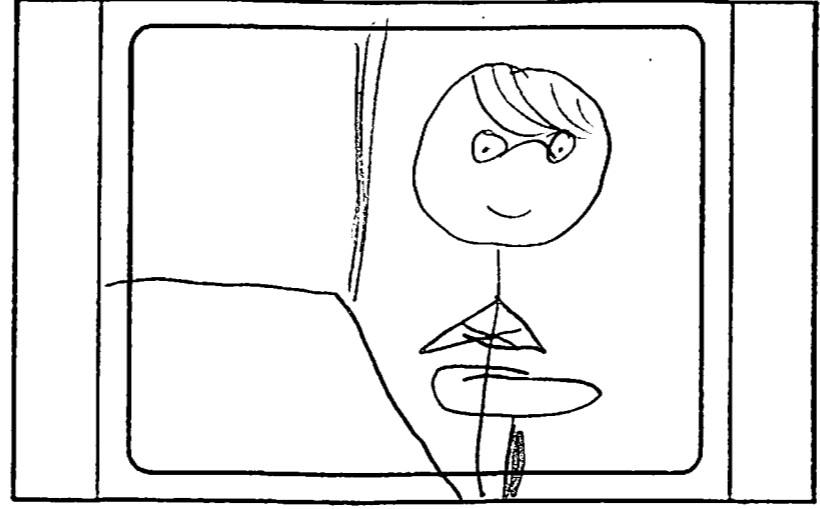

LOCATION: DAY NIGHT OTHER

ACTION Ellen smiles and looks satisfied.

DIAL

SLG

TRANS

cat

SC. PANEL BG.

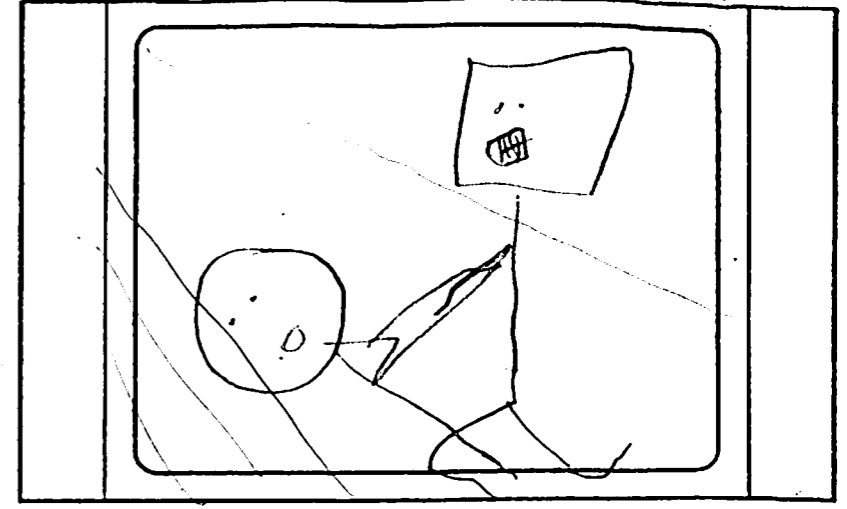

LOCATION: DAY NIGHT OTHER

ACTION Milt is looking at O.S. Ellen like, "You've got to be kidding me."

DIAL

SLG ...ing director

TRANS lation

cut

SC. PANEL BG.

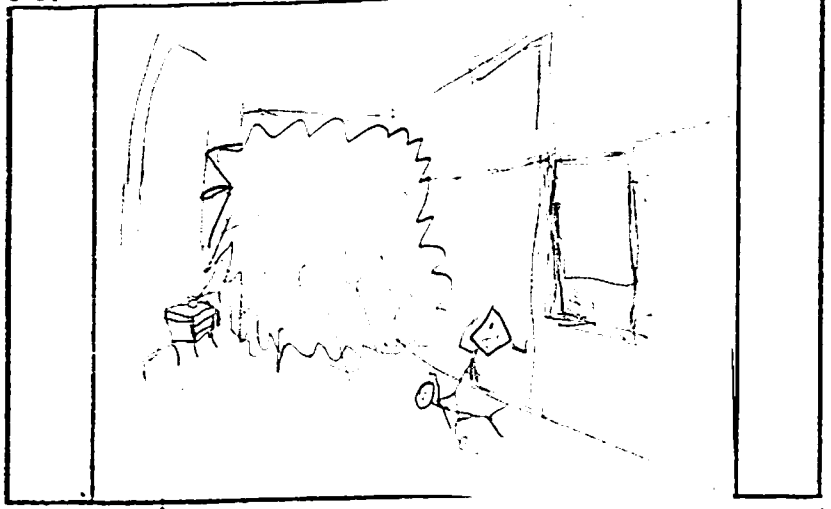

1:33 TV Safe LOCATION: DAY NIGHT OTHER 1:66

ACTION The wall SFX: Cexplodes and minion falls back and M.I.T rolls.

DIAL

SLG

TRANS

SC. cont PANEL BG.

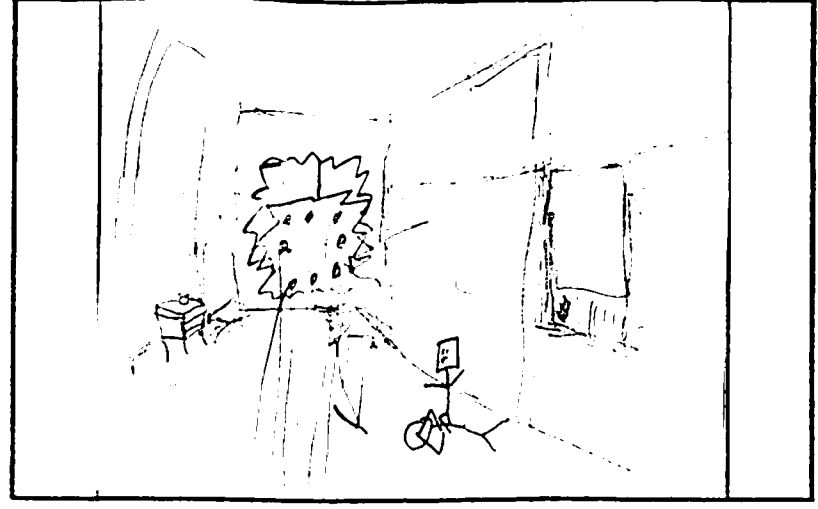

LOCATION: DAY NIGHT OTHER

ACTION A section of wall is pulled out by the grappling hooks. M.I.T covers his head.

DIAL

SLG

TRANS

cut

SC. PANEL BG. PAGE

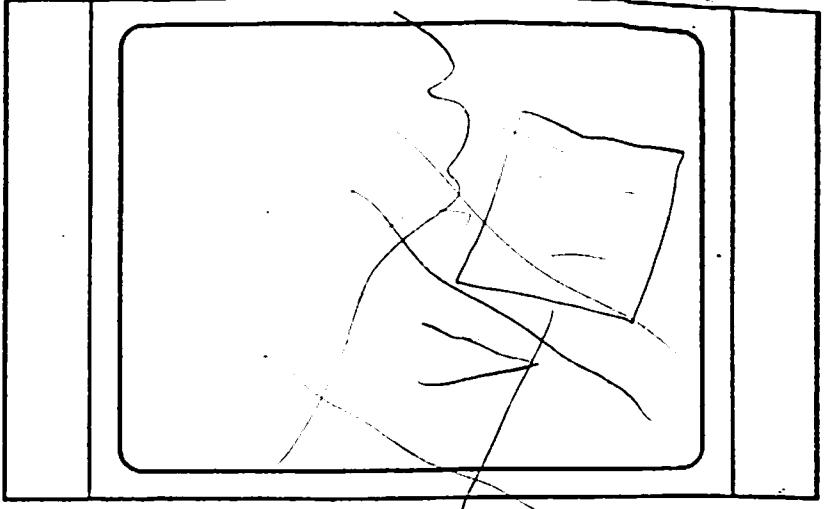

LOCATION: DAY NIGHT OTHER

ACTION The wall slams into a minion.

DIAL

SLG by director

TRANS lation

cut

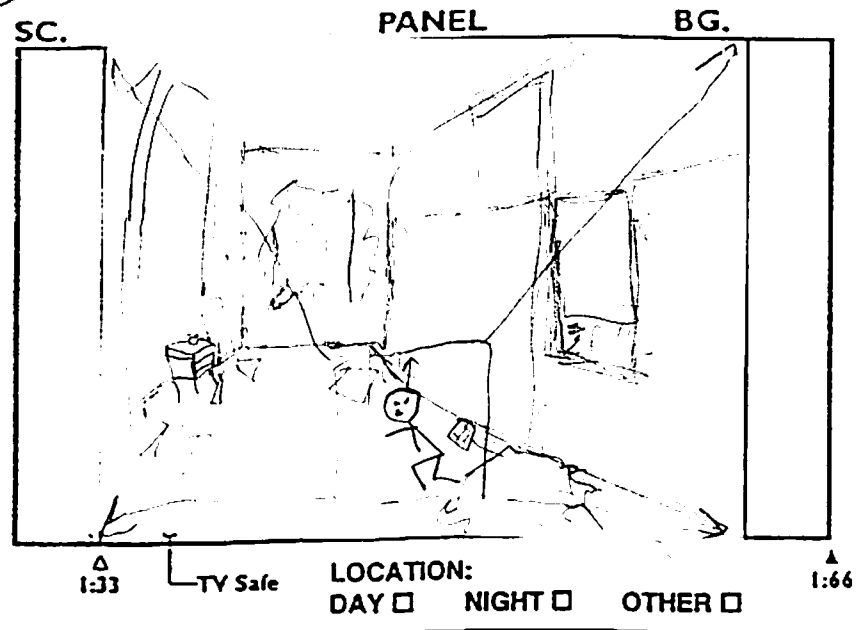

ACTION
Milt stands up and looks around at the mess.

DIAL
Milt: Hon, you're mad at me.

SLG

TRANS

cut

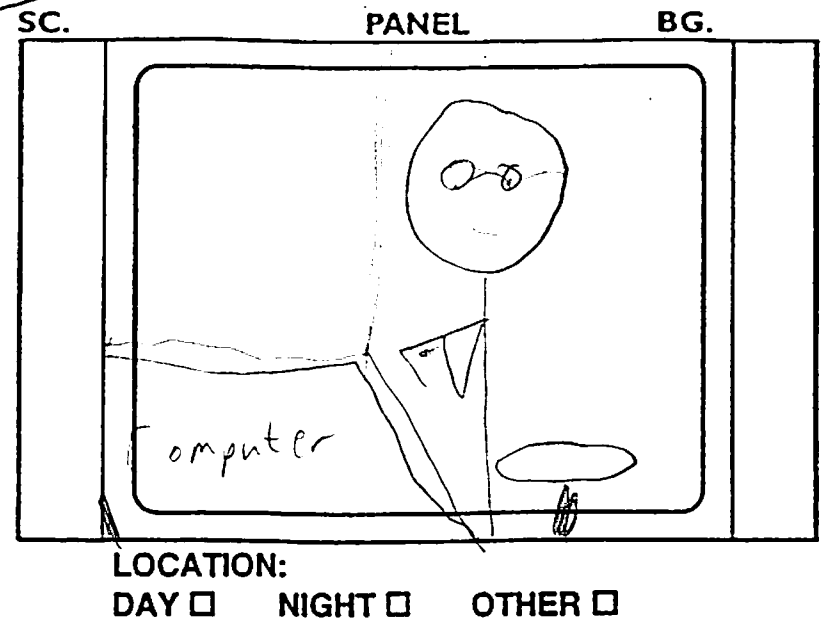

ACTION
Ellen dusts herself off.

DIAL
Ellen: It isn't a question of being mad at you. We've

SLG

TRANS

cut

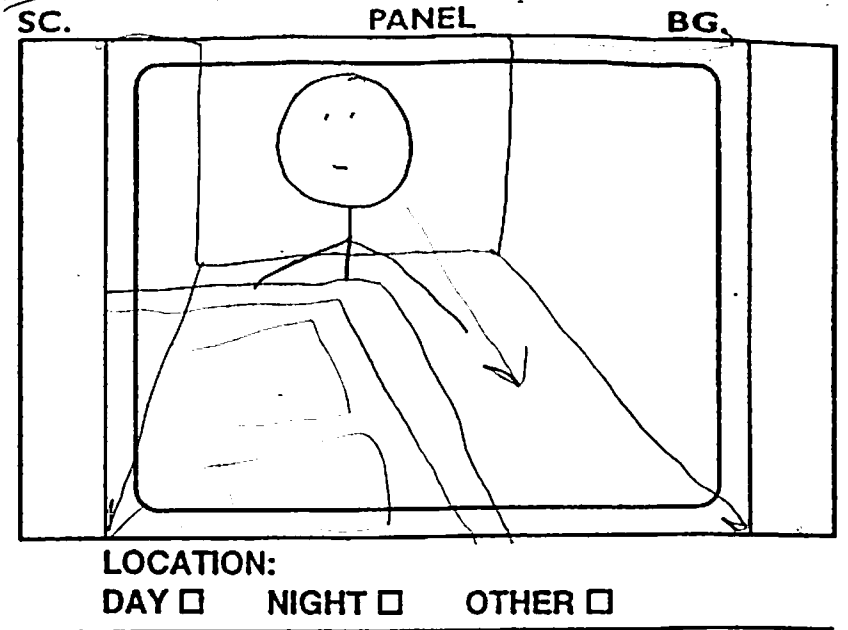

ACTION
Milt walks toward O.S. Ellen and stands by her computer.

DIAL
come a long ways from that.

SLG
ing director

TRANS
lation

cut

SC. PANEL BG.

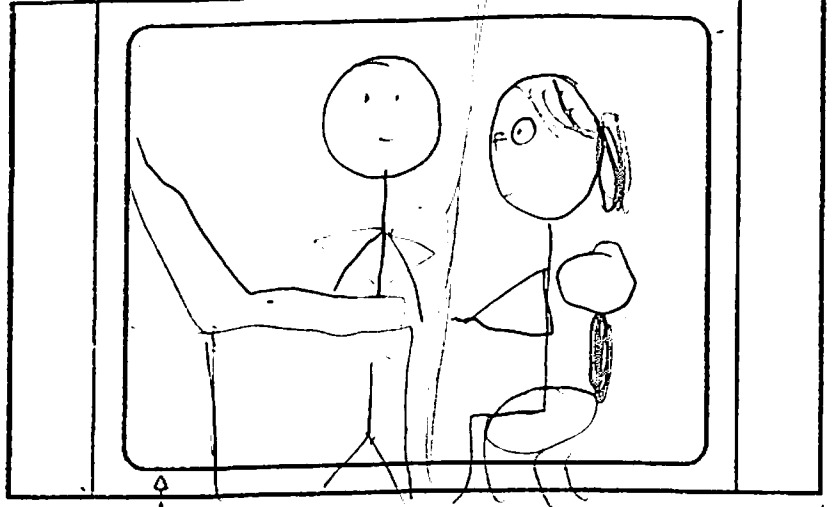

1:33 TV Safe LOCATION: DAY NIGHT OTHER 1:66

ACTION
Milt speaks softly to Ellen

DIAL
Milt: I see.

SLG

TRANS

cut

SC. PANEL BG.

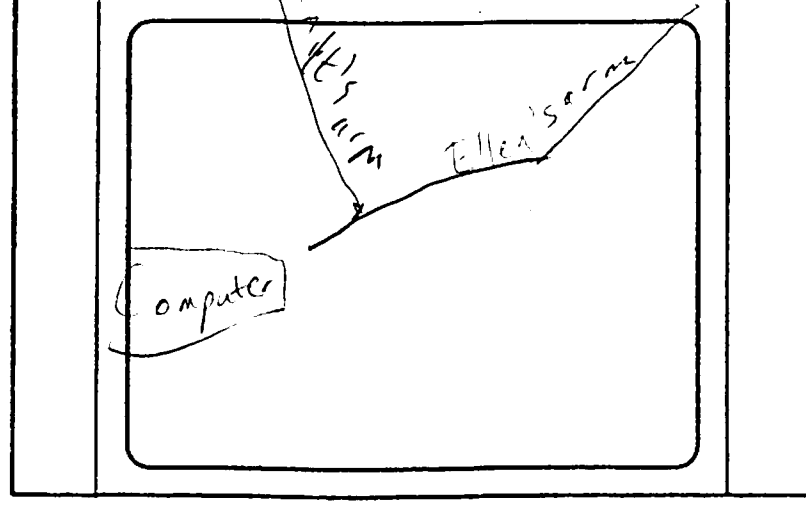

LOCATION: DAY NIGHT OTHER

ACTION
Milt catches Ellen's hand.

DIAL
Milt: Just the same

SLG

TRANS

cut

SC. PANEL BG.

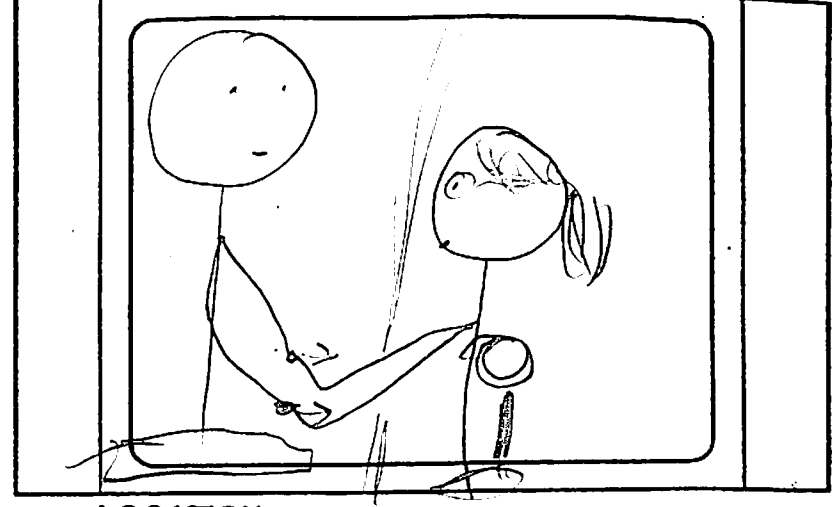

LOCATION: DAY NIGHT OTHER

ACTION
Milt catches her other hand, she tries to pull back, but she can't break free.

DIAL
I'd like to ask you something, El.

SLG
Ellen: ^{ing director} Speak. I can't stop you.

TRANS lation

SC. cont

PANEL

BG.

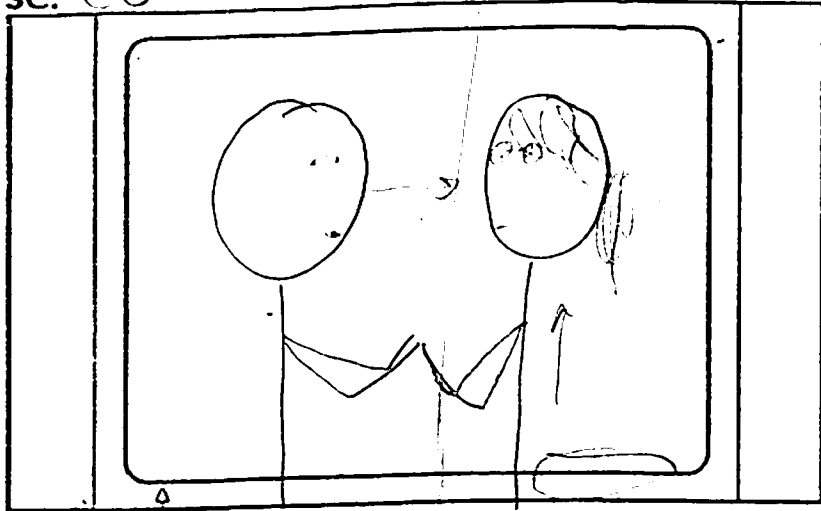

1:33 TV Safe 1:66
 LOCATION:
 DAY NIGHT OTHER

ACTION
 Milt pulls her up to a standing position, then leans in close

DIAL
 Milt: Do you think our marriage is a failure?

SLG

TRANS

cut

SC.

PANEL

BG.

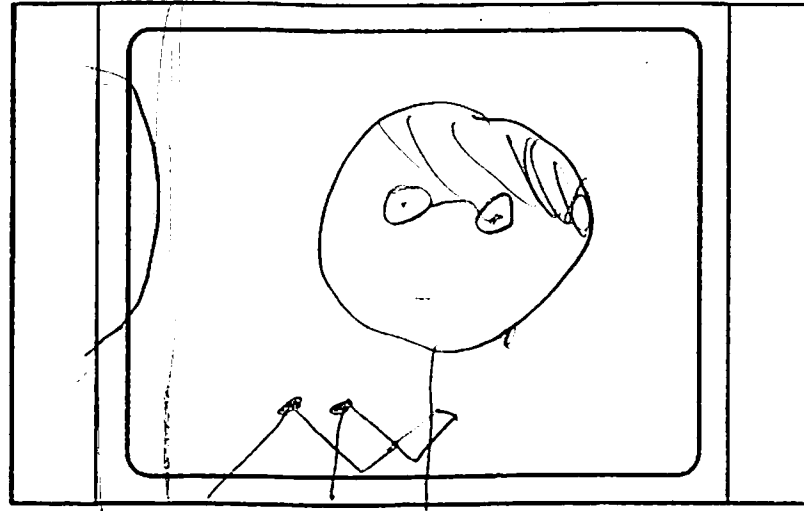

LOCATION:
 DAY NIGHT OTHER

ACTION
 Ellen thinks about it, then says:

DIAL
 Ellen (beat): I do.

SLG

TRANS

cut

SC.

PANEL

BG.

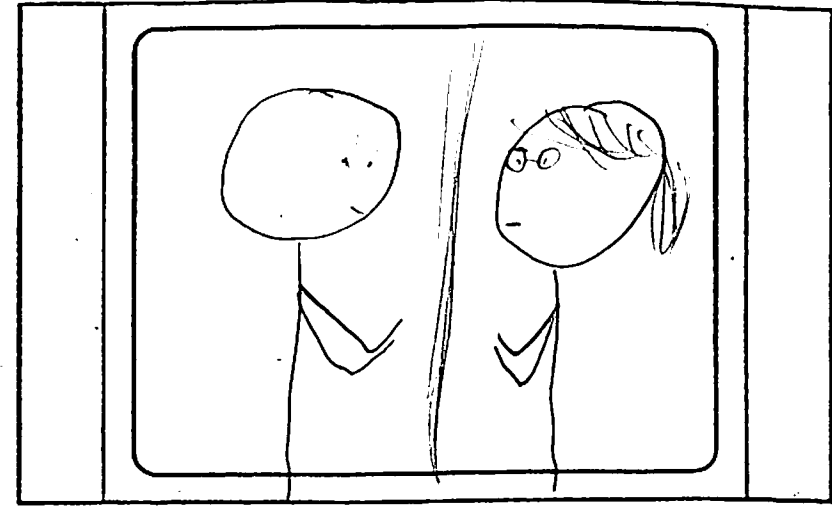

LOCATION:
 DAY NIGHT OTHER

ACTION
 Milt lets go.

DIAL
 Milt: I thought so.

SLG ending director

TRANS lation

cut

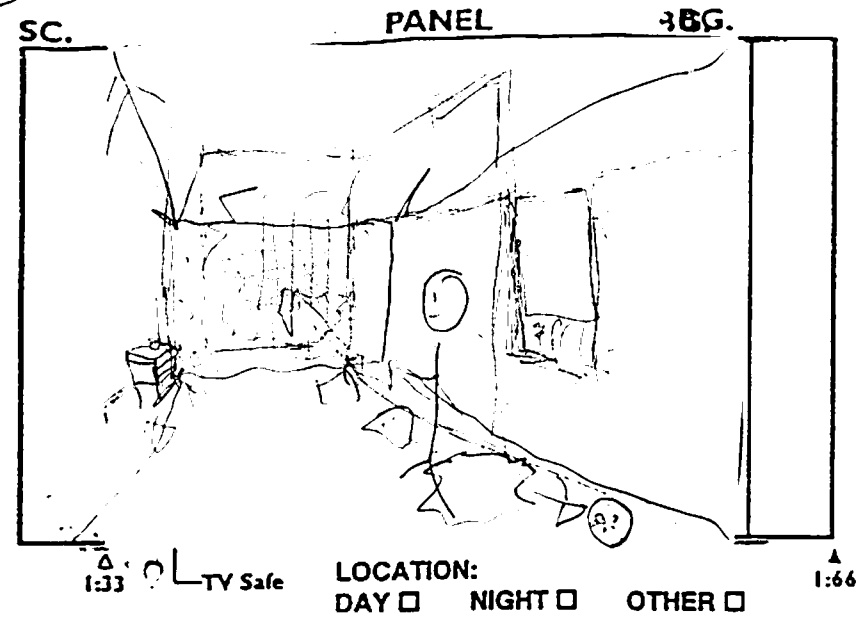

ACTION
Milt walks into the room behind the wall

DIAL
Milt: I thought that was behind it.

SLG

TRANS

cut

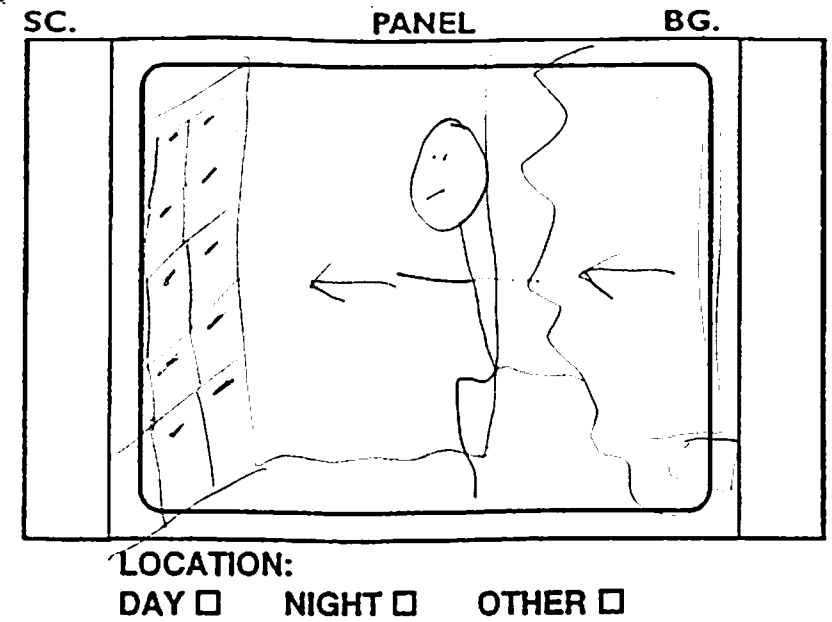

ACTION
The vault is full of drawers

DIAL

SLG

TRANS

SC. cont

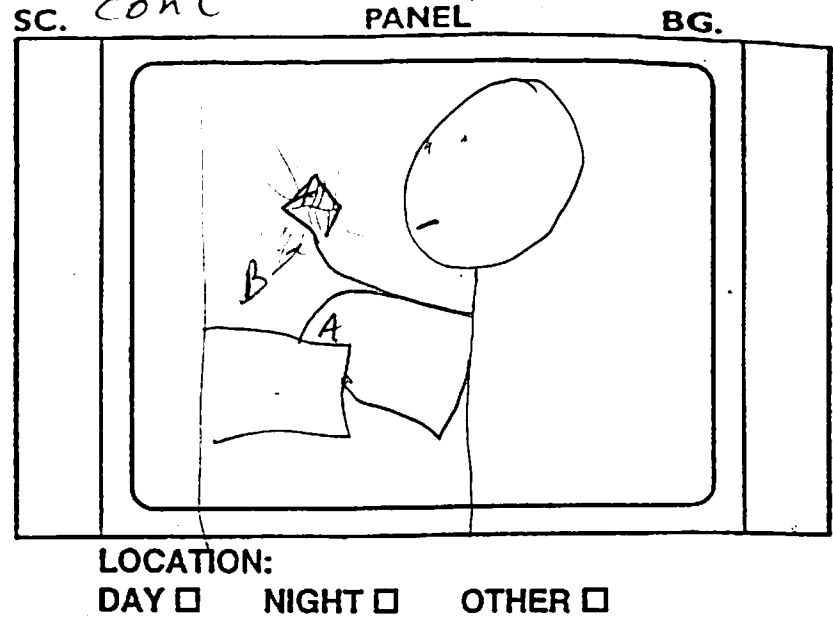

ACTION
Milt opens a drawer and reaches inside and B pulls out a glowing gem

DIAL
But before I give you a divorce

SLG ...ing director

TRANS lation

SC. PANEL BG.

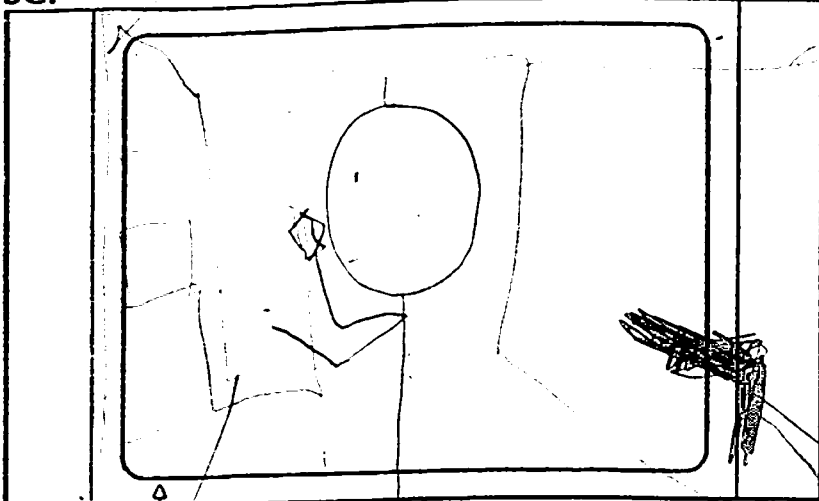

Δ 1:33 TV Safe LOCATION: DAY NIGHT OTHER Δ 1:66

ACTION

DIAL Ellen (O.S.): There isn't going to be a divorce

SLG Milt: There isn't?

TRANS

SC. PANEL BG.

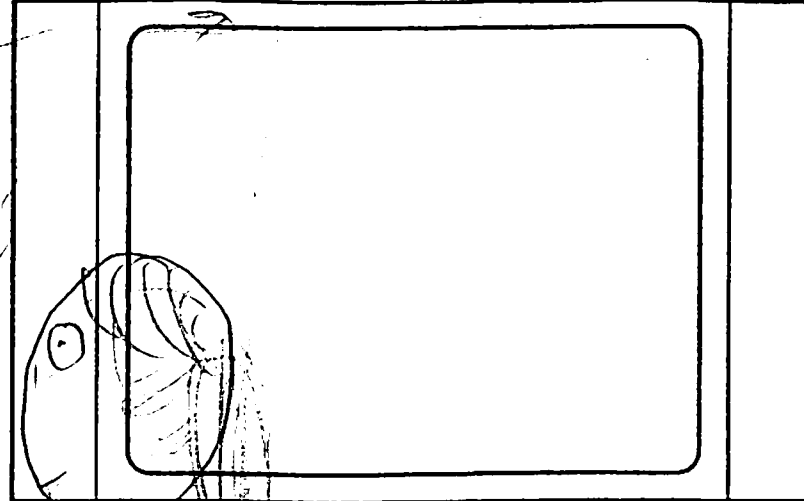

LOCATION: DAY NIGHT OTHER

ACTION

DIAL "There isn't?" as we pull back

SLG gun to Ellen.

TRANS

cut

SC. PANEL BG.



LOCATION: DAY NIGHT OTHER

ACTION

Ellen beckons with her hand for the gem.

DIAL Ellen: We've made a mistake, but we've got to make the best of it.

SLG ...director

TRANS /ation

cut

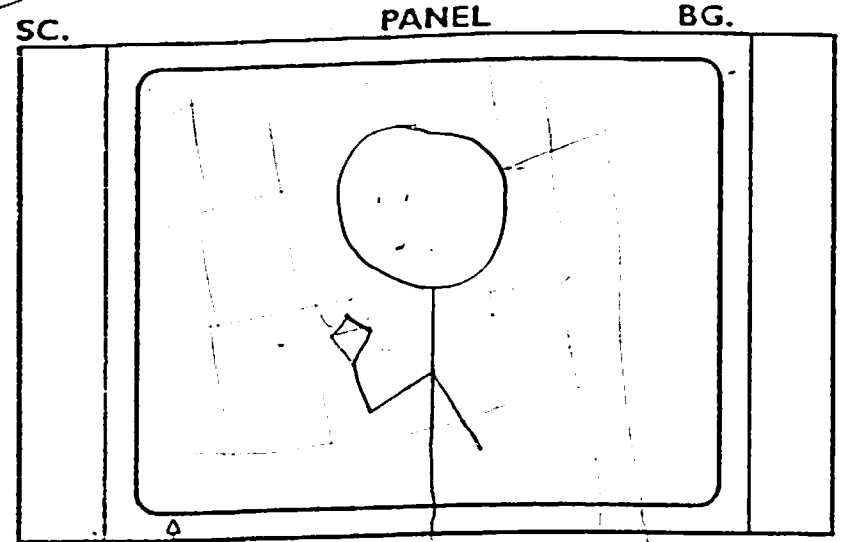

1:33 TV Safe LOCATION: DAY NIGHT OTHER 1:66

ACTION
Milt looks at the gem.

DIAL

SLG

TRANS

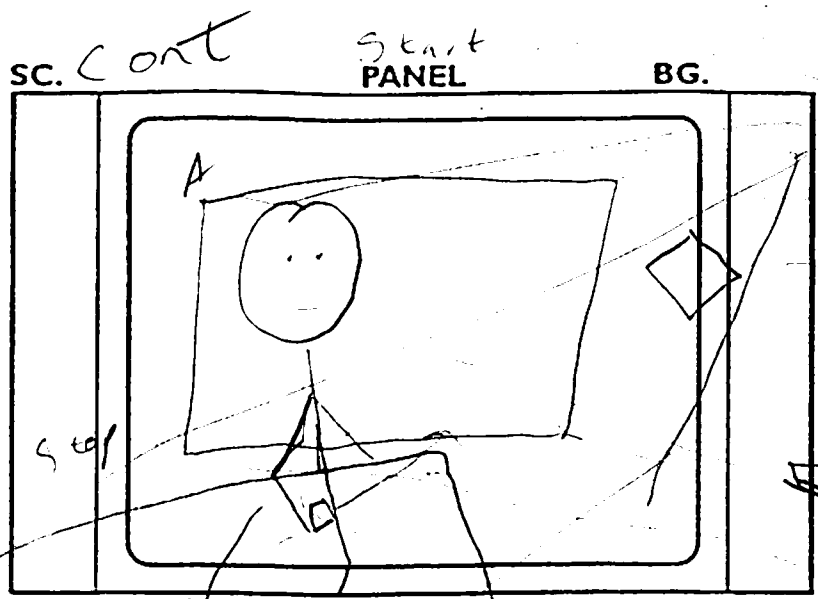

LOCATION: DAY NIGHT OTHER

ACTION
Milt throws the gem

DIAL

SLG

TRANS

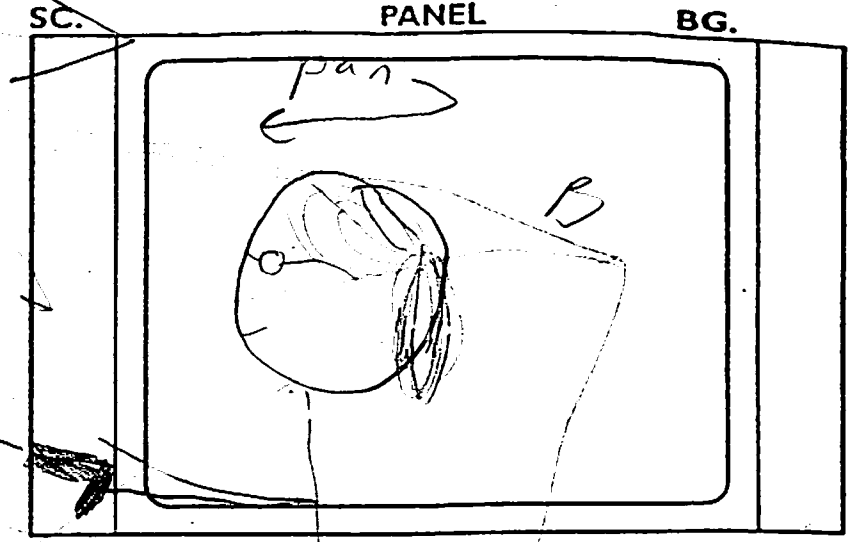

LOCATION: DAY NIGHT OTHER

ACTION

DIAL

SLG *ing director*

TRANS *lation*

Milt (A) throws the gem and we follow it to (B) where Ellen ^{sex} shoots as she catches it and (C) Milt dives out of the way.

cut

SC. PANEL BG.

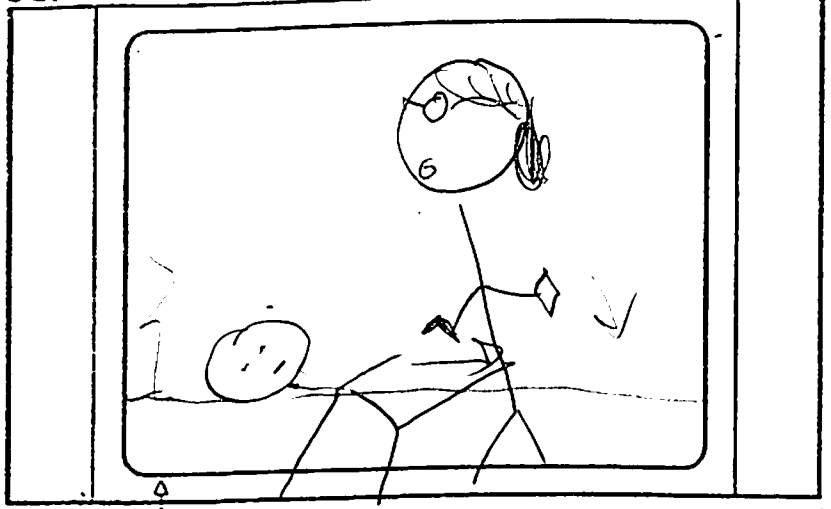

1:33 TV Safe LOCATION: DAY NIGHT OTHER 1:66

ACTION
Milt swings low and unbalances Ellen.

DIAL

SLG

TRANS

SC. cont PANEL BG.

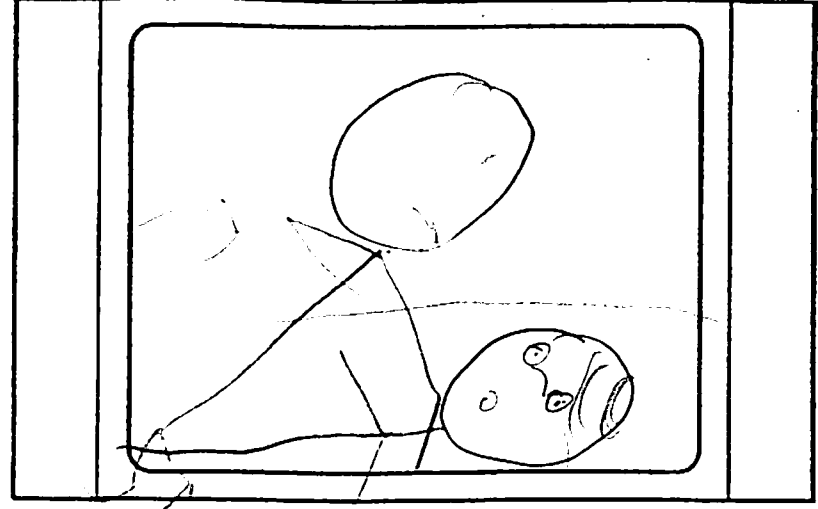

LOCATION: DAY NIGHT OTHER

ACTION
Milt holds Ellen down and raises his hand to punch her, but stops.

DIAL

SLG

TRANS

cut

SC. PANEL BG.

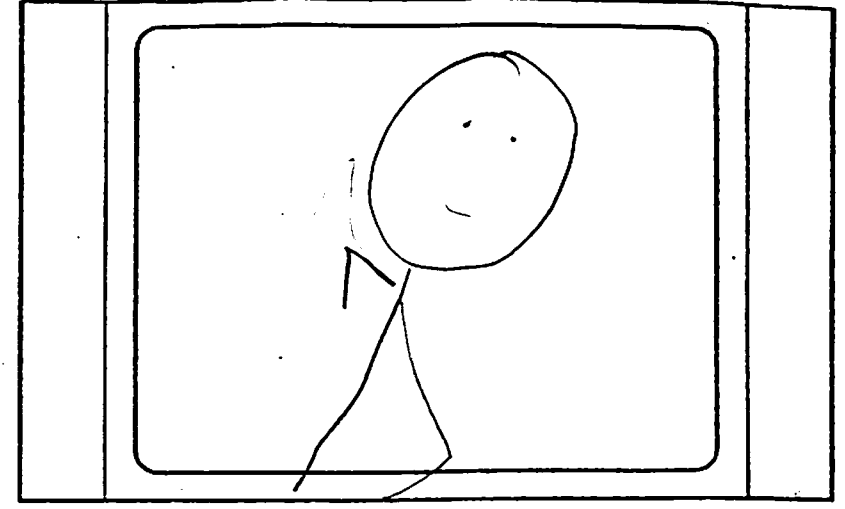

LOCATION: DAY NIGHT OTHER

ACTION
POV as Milt softens, relaxes his arm.

DIAL

SLG
ing director

TRANS
lation

cut

SC. PANEL BG.

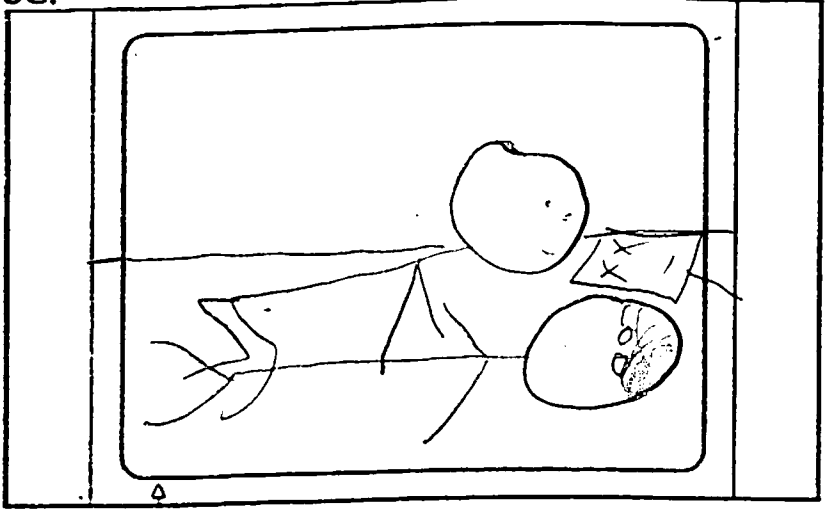

1:33 TV Safe LOCATION: DAY NIGHT OTHER 1:66

ACTION
Milt speaks and then pushes off of Ellen.

DIAL
Milt: We'll act liked civilized human beings.

SLG

TRANS

SC. cont PANEL BG.

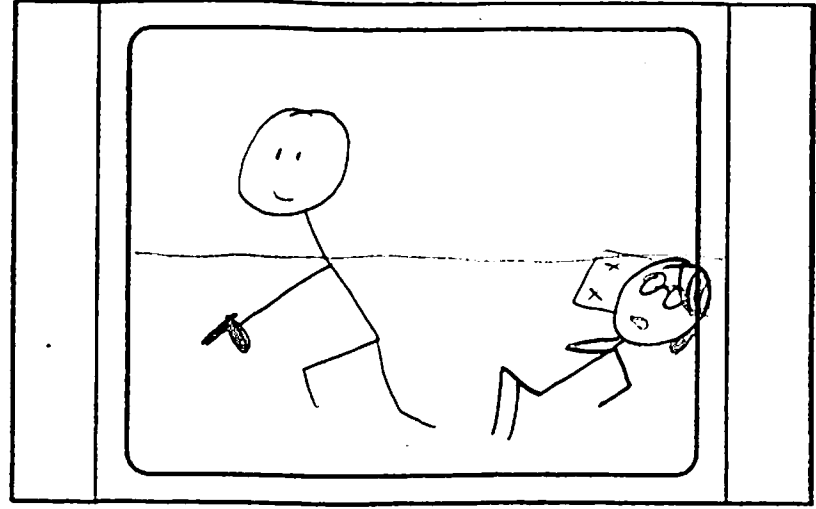

LOCATION: DAY NIGHT OTHER

ACTION
Milt picks up the gun as Ellen catches her breath.

DIAL
Ellen: I... have no intention

SLG

TRANS

SC. PANEL BG. PAGE _____

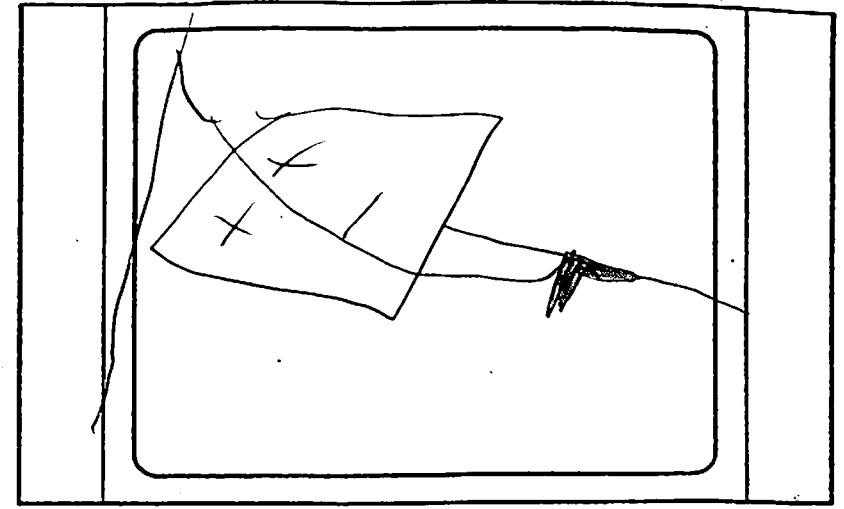

LOCATION: DAY NIGHT OTHER

ACTION
Ellen pulls a gun out of minions jacket (yes, jacket!)

DIAL
of doing...

SLG ...ing director

TRANS lation

cut

SC. PANEL BG.

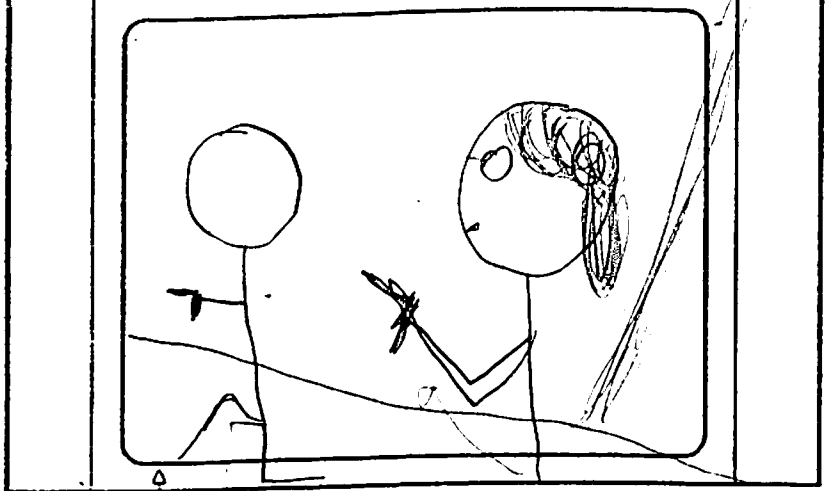

Δ 1:33 TV Safe LOCATION: DAY NIGHT OTHER Δ 1:66

ACTION
Milt's back is to Ellen as she pulls up the gun

DIAL
Ellen: otherwise.

SLG

TRANS

SC. cont PANEL BG.

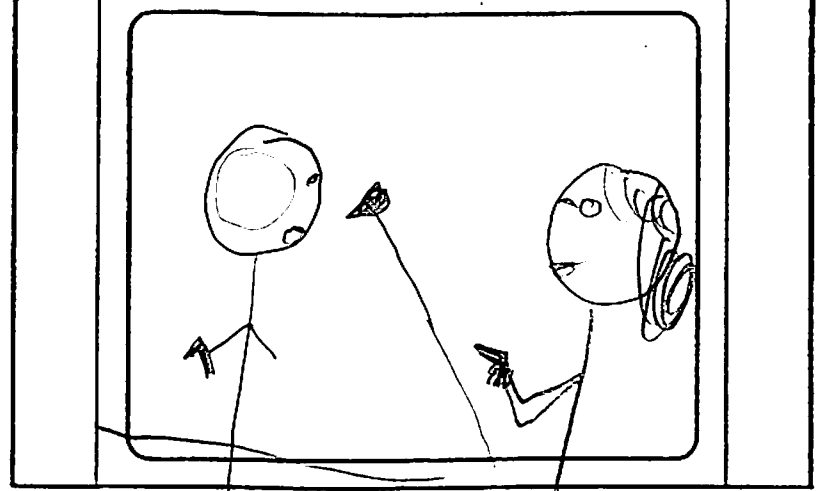

LOCATION: DAY NIGHT OTHER

ACTION
A grappling hook (SFX: Thunks) against the wall, getting Milt's attention and surprising Ellen.

DIAL

SLG

TRANS

SC. cont PANEL BG.

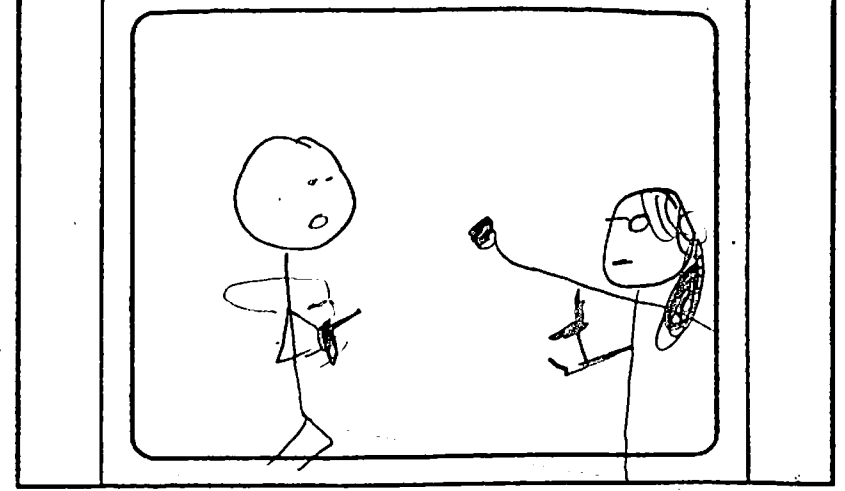

LOCATION: DAY NIGHT OTHER

ACTION
Milt spins but not in time to shoot. The grappling hook goes across Ellen's neck.

DIAL

SLG
ing director

TRANS
ation

cut

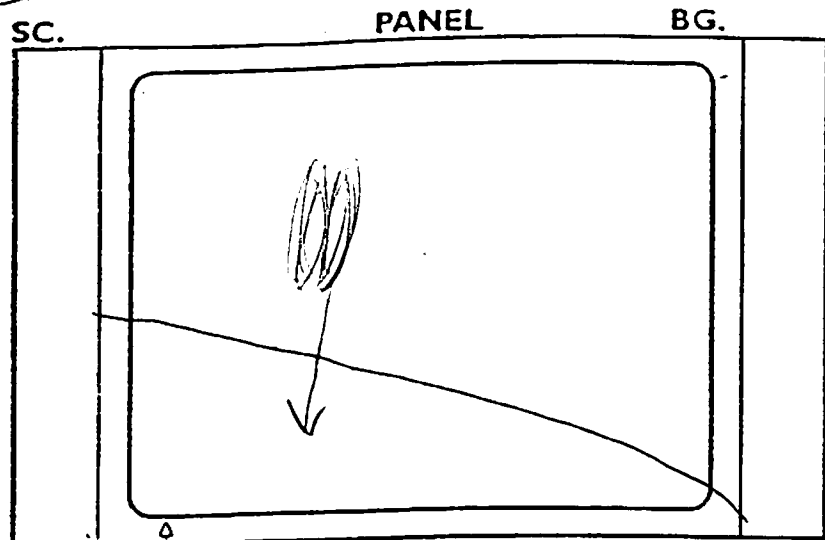

SC. BG.

Δ 1:33 TV Safe Δ 1:66

LOCATION: DAY NIGHT OTHER

ACTION
Part of Ellen's pony tail falls to the floor as we hear O.S. (SFX: thud).

DIAL

SLG

TRANS

cut

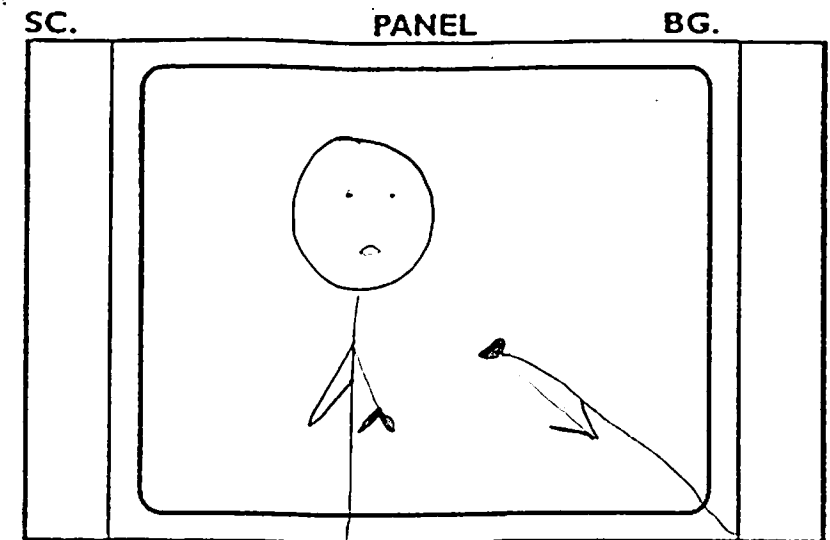

SC. BG.

LOCATION: DAY NIGHT OTHER

ACTION
Milt catches his breath as grappling hook retracts.

DIAL

SLG

TRANS

cut

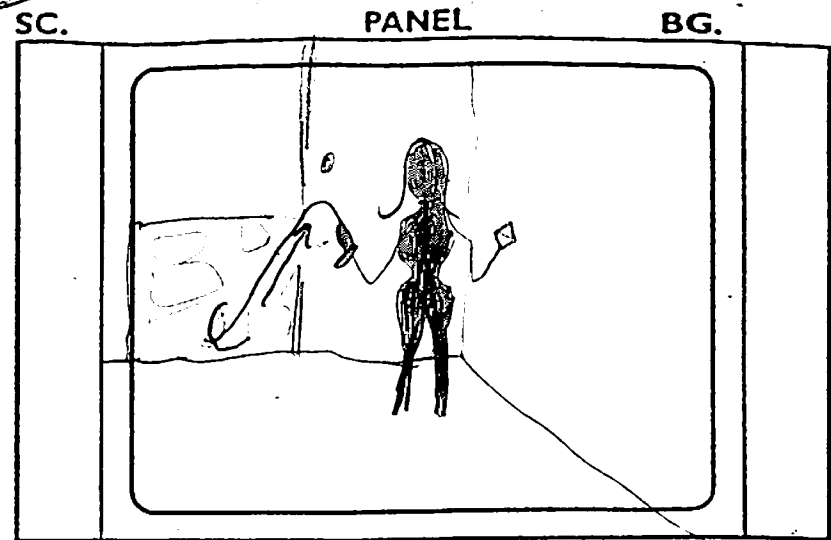

SC. BG.

LOCATION: DAY NIGHT OTHER

ACTION
Grappling hook retracts into gun, as mystery woman holds gem.

DIAL

SLG ing director

TRANS ation

cut

SC. PANEL BG.

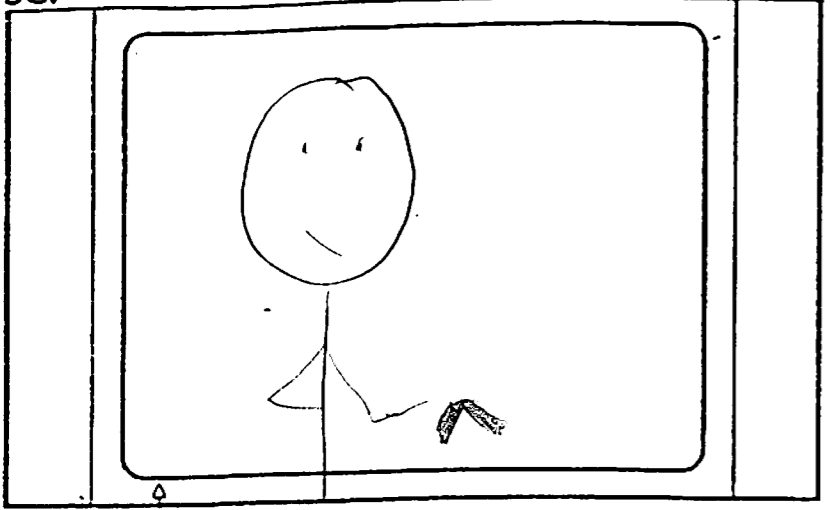

Δ 1:33 TV Safe LOCATION: DAY NIGHT OTHER Δ 1:66

ACTION
Milt nods, acknowledging woman's skill, and tosses the gun

DIAL
Milt: Good.

SLG

TRANS

cut

SC. PANEL BG.

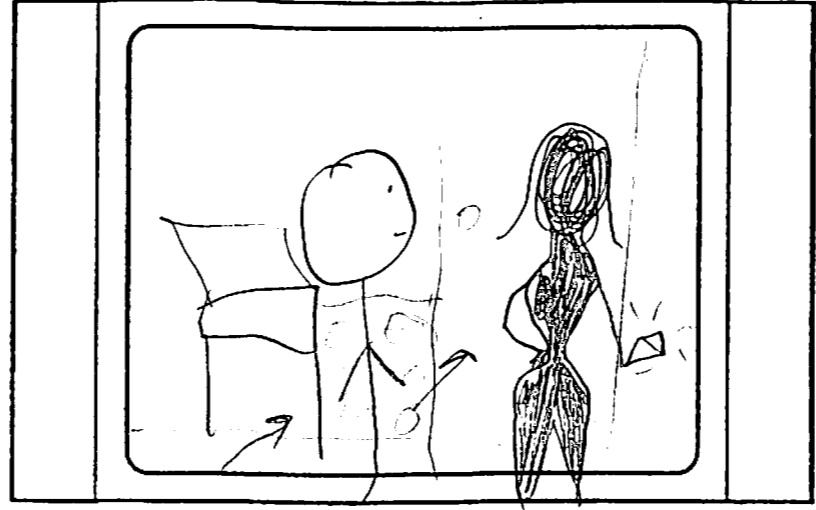

LOCATION: DAY NIGHT OTHER

ACTION
Milt moves up to mystery woman.

DIAL

SLG

TRANS

SC. cont

PANEL BG.



LOCATION: DAY NIGHT OTHER

ACTION
Milt and woman move to door. Milt looks over his shoulder.

DIAL

SLG ...ing director

TRANS lation

SC. PANEL BG.

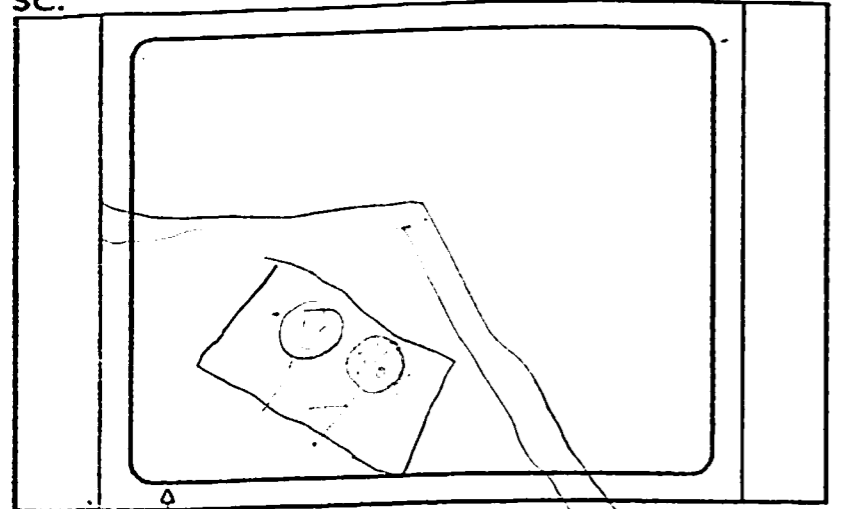

1:33 TV Safe LOCATION: DAY NIGHT OTHER 1:66

ACTION
The computer screen shows
- [unclear] -
to help [unclear]

DIAL

SLG

TRANS

^{cut} SC. PANEL BG.

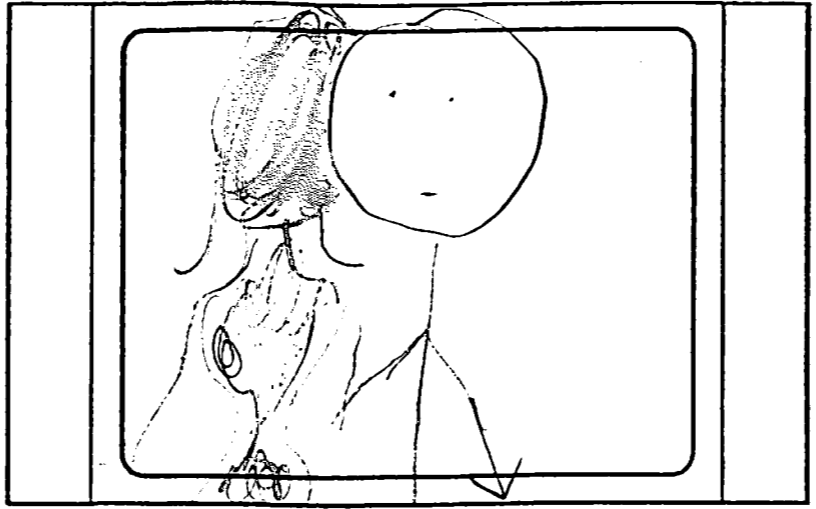

LOCATION: DAY NIGHT OTHER

ACTION
Milt looks wistful, leans
forward.

DIAL

SLG

TRANS

^{cut} SC. PANEL BG. PAGE

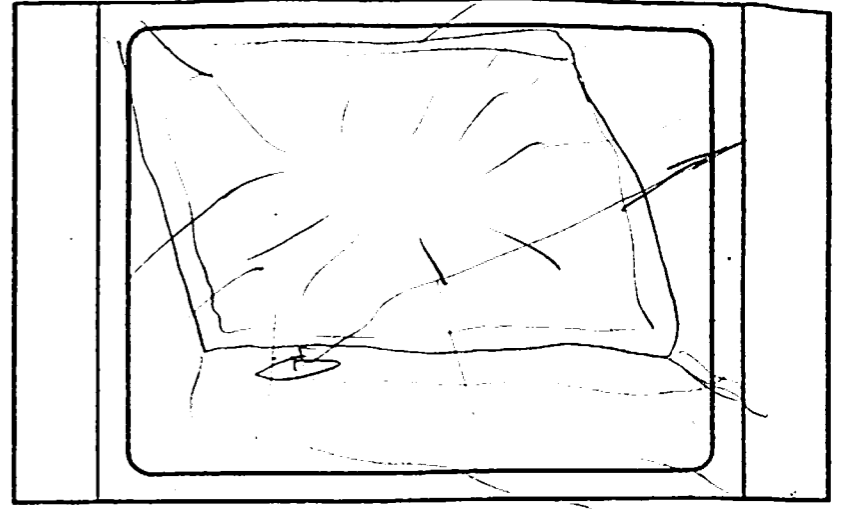

LOCATION: DAY NIGHT OTHER

ACTION
Milt presses the off button
and the picture disappears.

DIAL

SLG
- [unclear] director

TRANS
- [unclear] action